

8mm Surfaces Instalation Manual

DEKTON® MANUAL

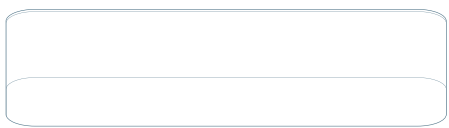

A product designed by **COSENTINO**





INDEX

GENERAL CHARACTERISTICS	4
HEAT	4
ADHESIVES	4
REINFORCEMENTS	5-6
SINKS	7-8

GENERAL CHARACTERISTICS

For 8 mm Dekton surfaces, mesh must be applied to the underside of the slab for greater robustness during transport and use. Cosentino guarantees and supplies slabs with mesh provided that they are destined for use as surfaces. Ideally the mesh should be applied at the plant, but if the customer wishes to use an external supplier a 300gr/m² fibreglass mesh should be used, adhered with epoxy resin.

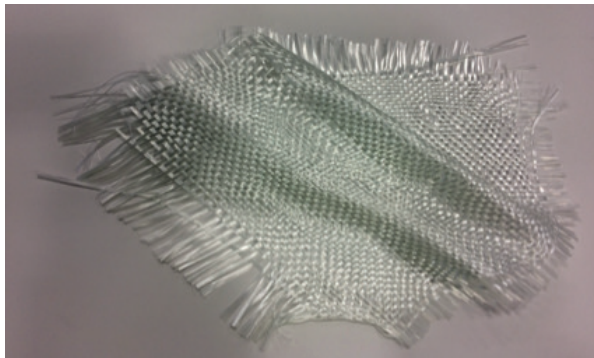

HEAT

It is not advisable to allow Dekton 8 mm to come into contact with sources of heat or hot objects. Heat pads or mats are recommended.

ADHESIVES

In order to glue elements to Dekton, such as skirting or internal reinforcements, **Mastidek adhesive** or epoxy resin should be used. Always apply a **continuous**

string of adhesive, avoiding spots of adhesive along the length of the piece.

REINFORCEMENTS

Perimeter reinforcements will be necessary for the front, sides and rear of the piece, as well as on the four sides of fittings, both for sinks and for hobs.

It is also advisable to use additional cross reinforcements every 30 cm for large surfaces such as islands.

These reinforcements can be fitted as follows:

OPTION 1. MITRED EDGE

- A) Rigid polyurethane foam
- B) Dekton / Granite

OPTION 2. STRAIGHT EDGE

-MDF wood plank

The two possible ideal surface models for using Dekton 8 mm.

Option 1

Section A-A'

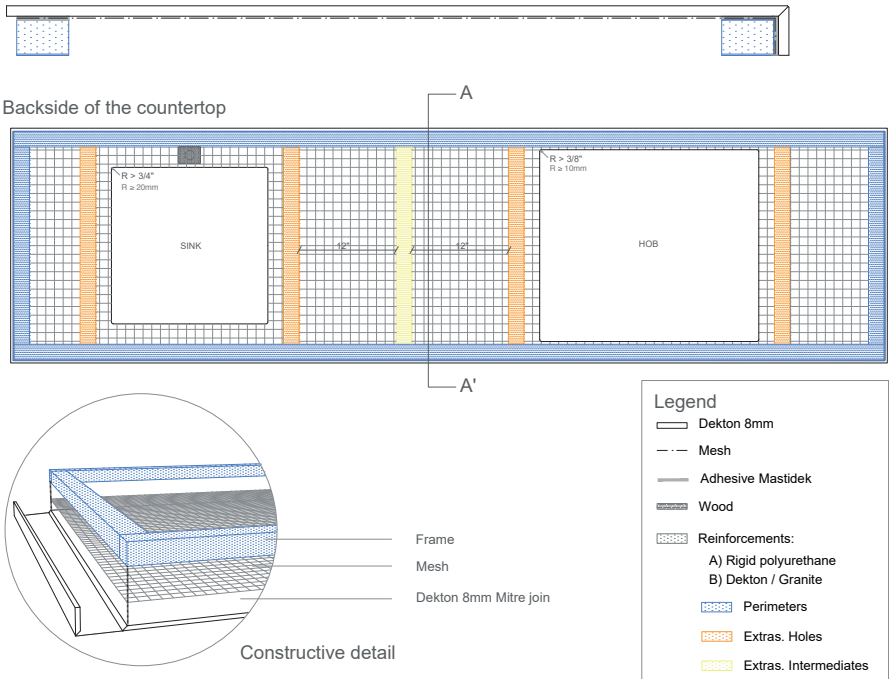

Option 2

Section A-A'

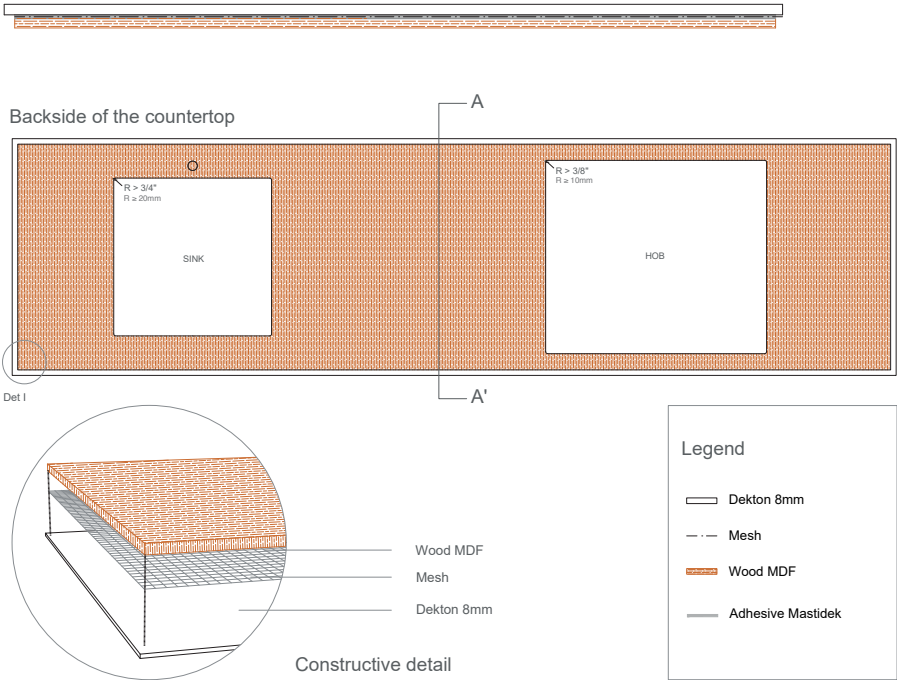

SINKS

For 8 mm Dekton surfaces, steel (or similar) sinks should always be used, and they should be top-mounted or flush with the worktop.

*Do not allow the worktop to bear the full weight of the sink.

TOP-MOUNT SINK

The edge is completely protected by the sink.

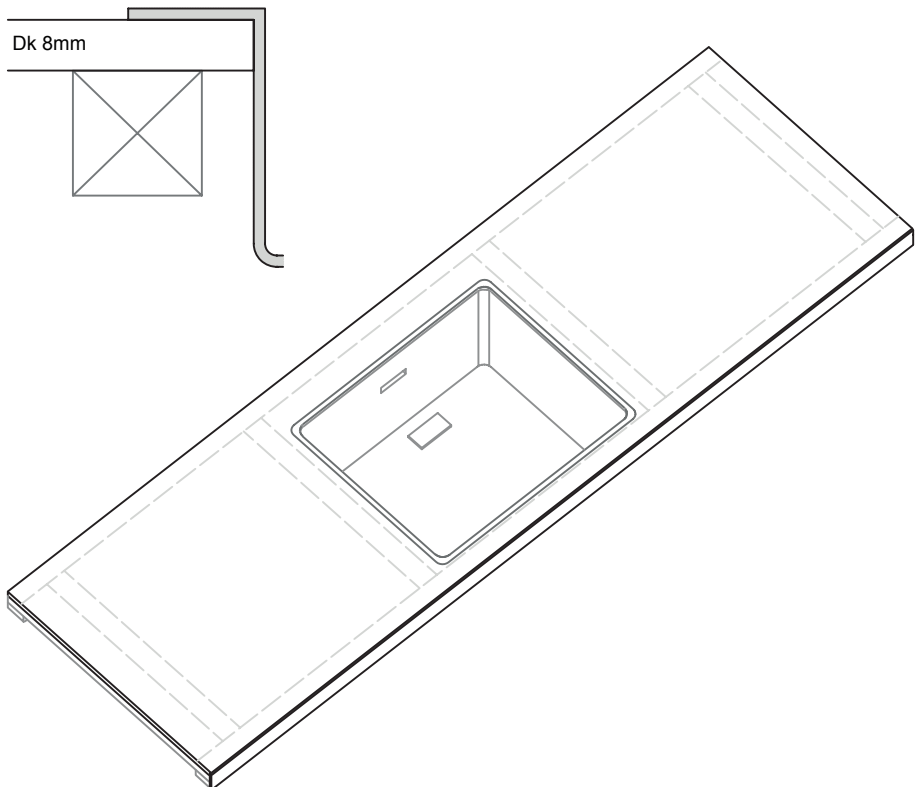

NOTE 1

A support bar should be used, resting either on the units or the floor, in order to ensure that the sink is perfectly fitted.

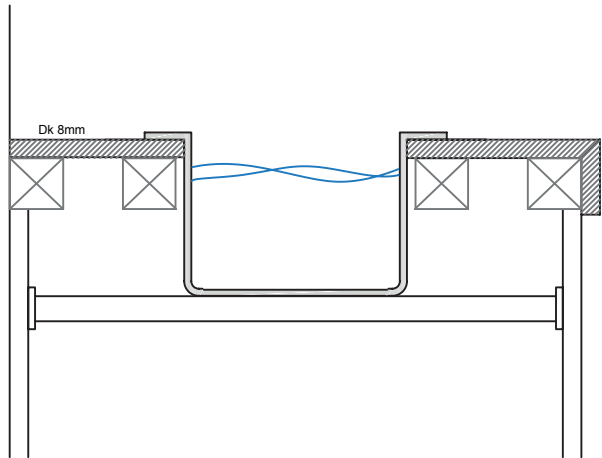

NOTE 2

Any holes and drilling should be made larger than the fixtures to avoid damaging the worktop.

Taps should not be screwed directly to the 8 mm Dekton worktop. A piece of work should be used between the two.

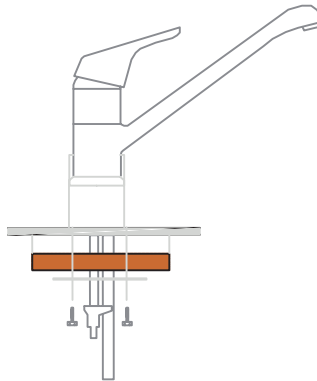



COSENTINO HEADQUARTERS

Ctra. Baza a Huércal - Overa, km 59 / 04850 - Cantoria - Almería (Spain)
Tel.: +34 950 444 175 / Fax: +34 950 444 226 / info@cosentino.com
www.cosentino.com / www.silestone.com / www.dekton.com / www.scalea.es



VI - OCT17