

Aura Bookmatch fabrication Manual

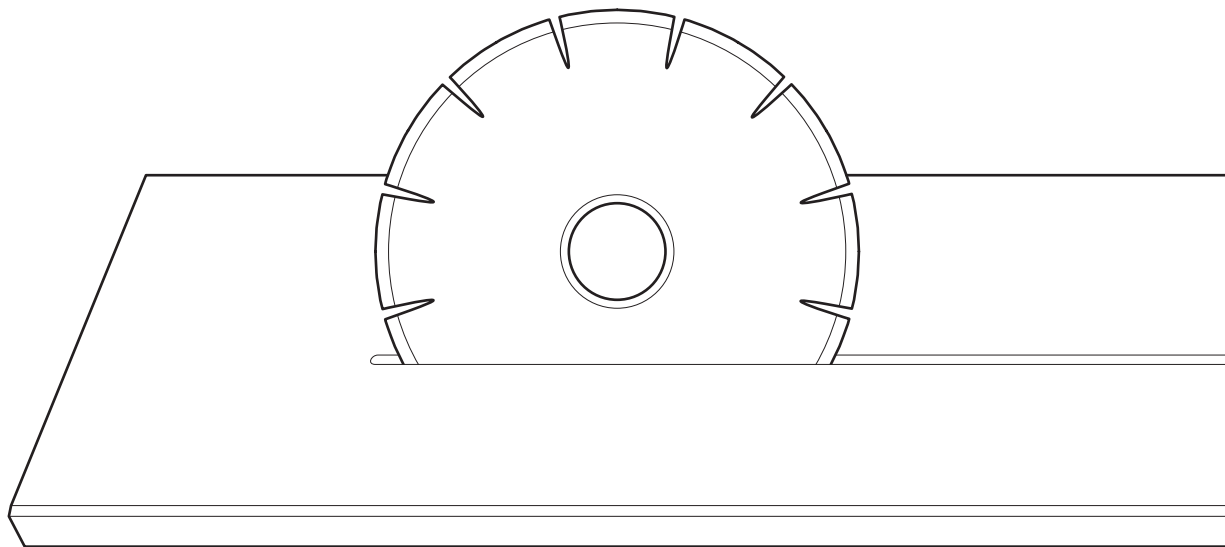

This document gathers the steps to undertake for a successful manufacture of **DEKTON AURA BOOKMATCH** enquiries.

Firstly, it is highly recommended to carefully read the Aura Bookmatch Catalogue, where 8 different designs are shown:

<http://content.cosentino.com/alldocuments/dekton/catalogs/brochures/Aura-15-Brochure-DE-IT-ES-EN-SV-PT-DU-FR.pdf>

Index

- 1. Technical Office Work
 - 1.1. Establish References
 - 1.2. Setting Out
 - 1.3. Reference List
 - 1.4. Identification
 - 2. Workshop Manufacture
 - 2.1. Cutting
 - 2.2. Matching
 - 2.3. Packaging
-

1

Technical Office Work

The technical office work is especially important regarding how to perform a job of Aura Bookmatch

1.1 Establish References

Since Aura Bookmatch is made up from 8 slabs with different vein patterns, it is really important to schematize each of them in references. Therefore, if the slabs are to be cut in pieces, each piece must be also referenced.

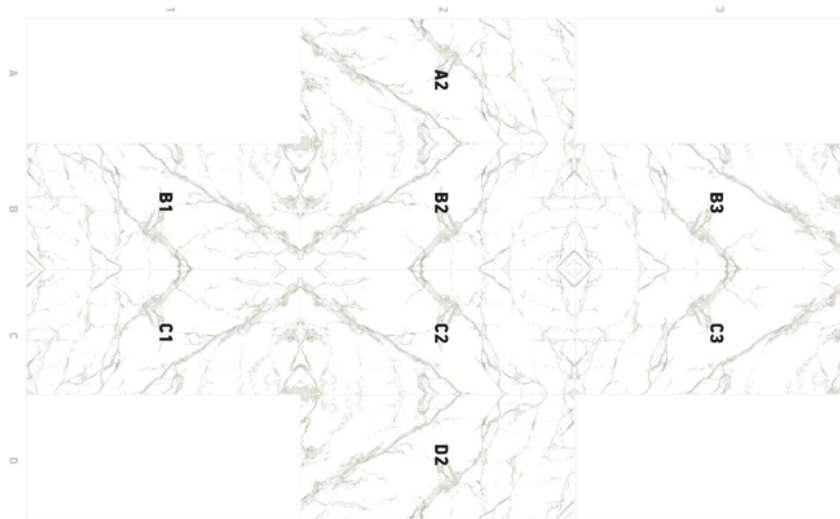

For example, in the following inquiry we are able to see that every Aura Bookmatch referenced pattern has been used, each of them divided in 3 pieces with identical dimensions (1,39m x 1,04m). This reference sheet must be part of the inquiry under the operator responsible for cutting.

Pieces reference
Dimension of pieces
139 x 104 x 0.8 cm

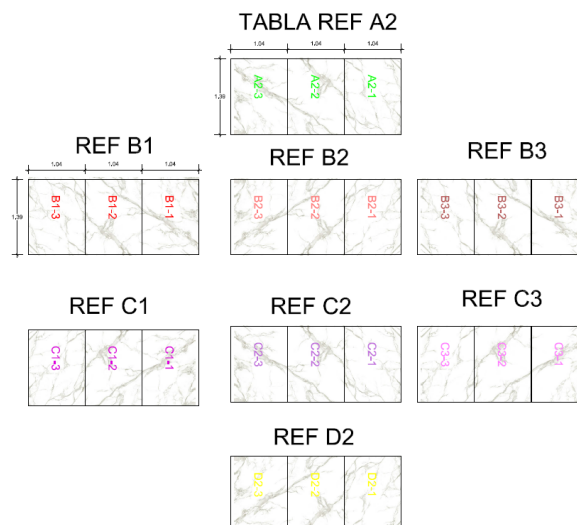

1.2

Setting Out

Once all the pieces have been identified, let's proceed to the setting out of pieces in the entire work area, imitating the wanted drawing or pattern. Take a look over the following **SETTING OUT**, as part of the example.

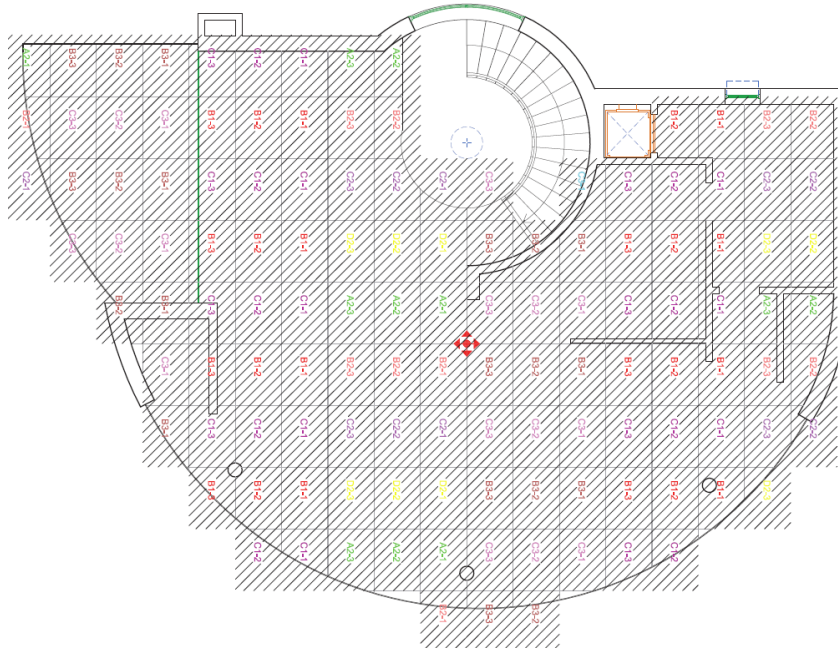

1.3

Reference List

After finishing the setting out, we will be able to make the inquiry to Cosentino regarding the necessary slabs for the job at hand. To this end, the necessary number of pieces for each reference must be kept in mind, therefore the number of slabs related to each reference must be considered as well. It is really important to check and ensure all the slabs belong to the same production and have the same colour tone, to ensure the greatest possible continuity. Take a look over the following **REFERENCE LIST**, as part of the example.

CANTIDAD PIEZAS	REF	REFERENCIA TABLA	CANTIDAD TABLAS
3	A2-1	A2	4
4	A2-2		
4	A2-3		
8	B1-1	B1	8
8	B1-2		
7	B1-3		
3	B2-1	B2	4
4	B2-2		
4	B2-3		
7	B3-1	B3	7
7	B3-2		
6	B3-3		
8	C1-1	C1	9
9	C1-2		
8	C1-3		
3	C2-1	C2	4
4	C2-2		
4	C2-3		
7	C3-1	C3	7
5	C3-2		
6	C3-3		
2	D2-1	D2	4
3	D2-2		
4	D2-3		
128			47

1.4 Identification

Finally, just before proceeding to cut at the workshop, it is recommended to identify each and every piece. Depending on the project scope, it is possible to find the case where several pieces belong to many different references, consequently identifying each piece will prevent confusions while cutting and installing it. Take a look over the following **PIECES IDENTIFICATION**, as part of the example.

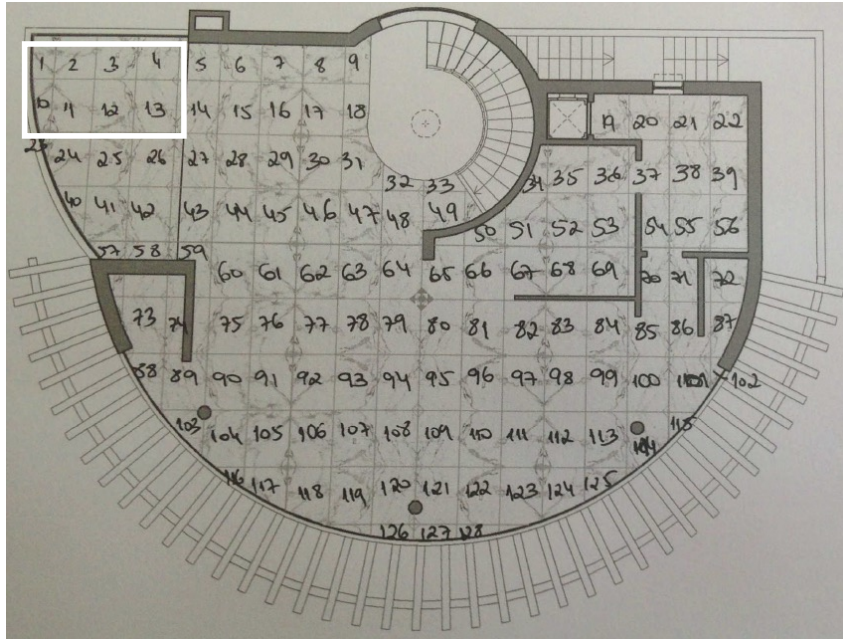

2

Workshop Manufacture

Once the enquiry is been properly identified in detail, and after receiving the slabs at the workshop, let's proceed to cut the pieces.

2.1 Cutting

To ensure continuity among the veins in slabs with different patterns, the adjacent pieces must be cut using the same measures and the same side. In order to make a cut in the right place, it is highly recommended to take references from the vein and, from this vein, measure it in order to make the cutting. Take a look over the following example, cutting the pieces 2-3-4-11-12-13.

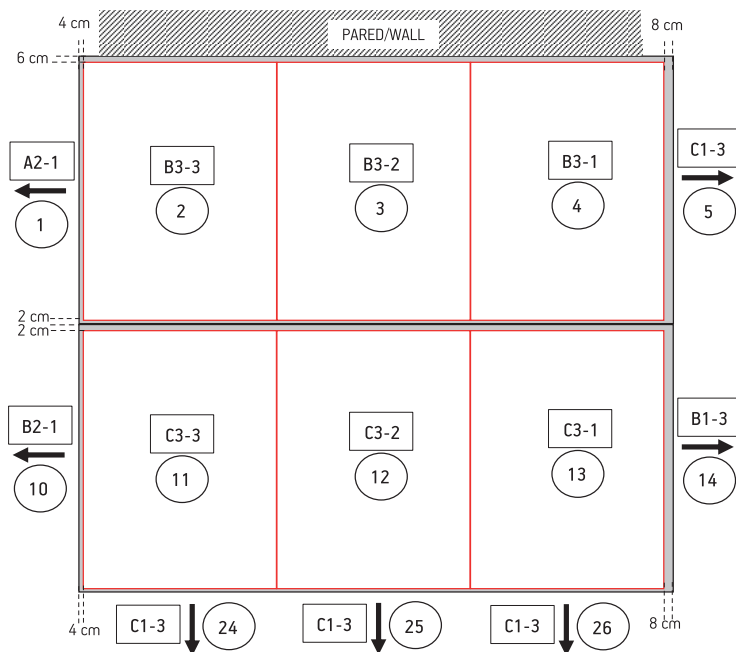
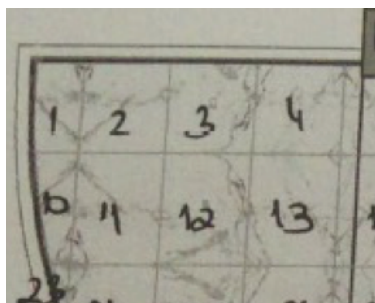

Once the cuts are marked, it is recommended to identify each piece with its assigned reference. It is also convenient to identify on the edges those references that will be placed next to each piece (adjoining pieces).

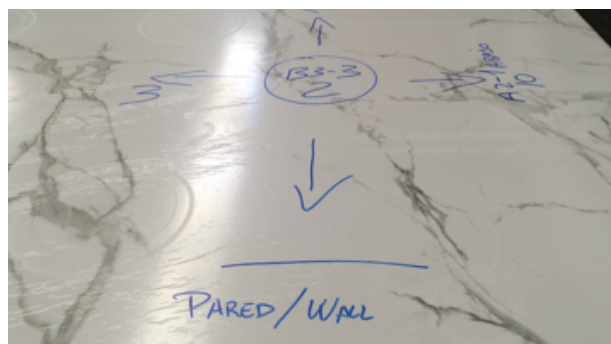
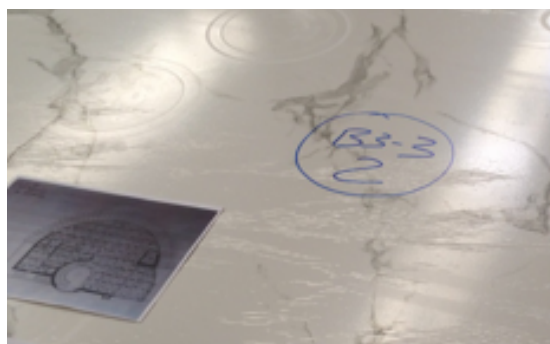

Use the recommended tools and parameters when making the cutting.

Make a micro bevel when finishing the edges in order to prevent chipping during transportation, handling or during worksite placement.



Before cutting each slab, it is important to mark each cut point and identify each piece with the pertinent references. Besides, it is recommended to gather the already cut adjoining pieces together, in order to check the perfect vein matching. Pay special attention to the main or more characteristic veins. Once the vein matching is being checked, mark the final cut points and proceed cutting. Repetir este proceso para el corte de todas las tablas.



Repeat this procedure for cutting every slab.

2.2 Matching

Once the cutting is finished (completely or by sectors, depending on the project scope or size), it is recommended to match every piece in the floor. This will allow you to check the exact cuts results and identify possible mistakes in the numbers or references.

Note: Keep in mind that the final placement will include a 2 or 3 mm joint, therefore those small discontinuous differences in the veins will not be perceptible.

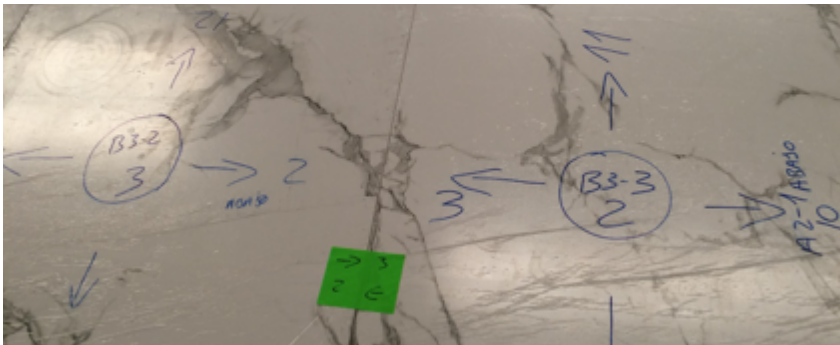
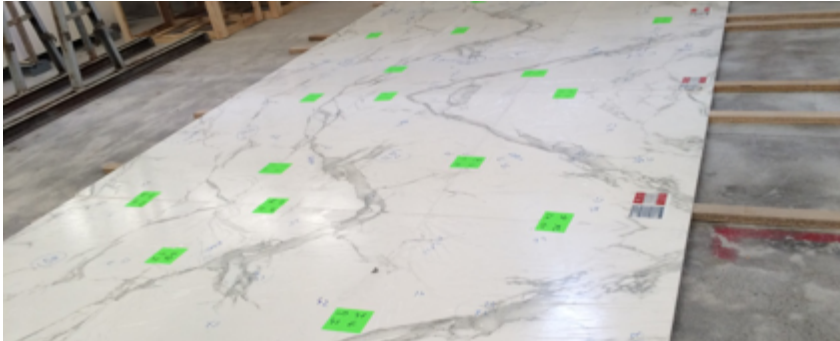

2.3 Packaging

Once checked that every single piece has been properly cut, numbered and referenced, let's proceed to set up the packaging.

To carry out the packaging, it is recommended to do it regarding the placement order on site. This means to load the pieces in order on each trestle work. To achieve this, it will be necessary to know the proper order placement on site, gathering trestle together by sectors, and loading the pieces in the same placement order. By doing this, handling the pieces on site will be very simplified. Those pieces installed in first place must be loaded in the outer part of each trestle. While the inner part must be loaded with the following ones, always in order.

Each trestle will have attached a "packing list", in which the included pieces will be detailed.

PROJECT:

CARA A

CARA B

EXT

INT

EXT

FABRICATED BY / FABRICADO POR:

COSENTINO

MATERIAL / MATERIAL:

DEKTON AGRA 8mm

CRATE CAJON	UNIT	ESTANCIA	STONE NAME REF	UN	WEIGHT kg	LENGTH cm	WIDTH cm	m2
PALET 4_ZONA 1	SOLERÍA		CARA A / FACE A					
			INTERIOR					
			X 27	1	30,358	139	104	1,45
			X 43	1	30,358	139	104	1,45
			X 59	1	30,358	139	104	1,45
			X 74	1	30,358	139	104	1,45
			X 89	1	30,358	139	104	1,45
			X 103	1	30,358	139	104	1,45
			X 116	1	30,358	139	104	1,45
			X 104	1	30,358	139	104	1,45
			X 90	1	30,358	139	104	1,45
			X 75	1	30,358	139	104	1,45
			X 60	1	30,358	139	104	1,45
			X 44	1	30,358	139	104	1,45
			X 28	1	30,358	139	104	1,45
			X 15	1	30,358	139	104	1,45
			X 6	1	30,358	139	104	1,45
			EXTERIOR					
			CARA B / FACE B					
			INTERIOR					
			X 2	1	30,358	139	104	1,45
			X 57	1	30,358	139	104	1,45
			X 41	1	30,358	139	104	1,45
			X 25	1	30,358	139	104	1,45
			X 12	1	30,358	139	104	1,45
			X 3	1	30,358	139	104	1,45
			X 4	1	30,358	139	104	1,45
			X 5	1	30,358	139	104	1,45
			X 14	1	30,358	139	104	1,45
			X 13	1	30,358	139	104	1,45
			X 26	1	30,358	139	104	1,45
			X 42	1	30,358	139	104	1,45
			X 58	1	30,358	139	104	1,45
			X 73	1	30,358	139	104	1,45
			88	1	30,358	139	104	1,45
			EXTERIOR					
TOTAL			Palet de 140 cm		29	910,728 kg		M ² 43,37

Every trestle must be protected with cork, rubber or elastic band.



SAfter loading every piece on the pertinent trestle, secure the load with hoops, preventing direct contact between the hoops and the edges of each piece.

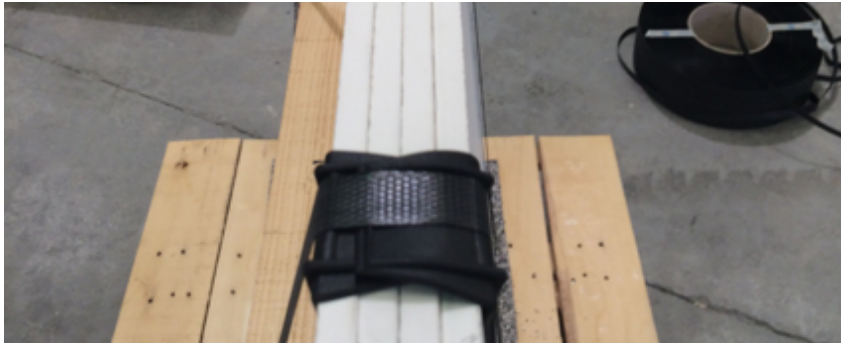

To improve even more the trestle identification, it is recommended to stick a label in the last piece, detailing the pieces in each side of the trestle. Additionally, it is also recommended to identify each piece by indicating its reference in each edge.

