

Rainfloors

Quick guide

Installation process

a. Check the dimensions of the substrate for the shower area and ensure that the chosen drainage system fits into the available space.

This substrate must be continuous, flat and leveled.

Consider where the drainage system is to be placed. Depending on this, it may or may not be necessary to chip away a part of the substrate to insert the drain pipe.

The finishing level of the tiles, the available height and the manufacturer's recommendations must be taken into account for installation.

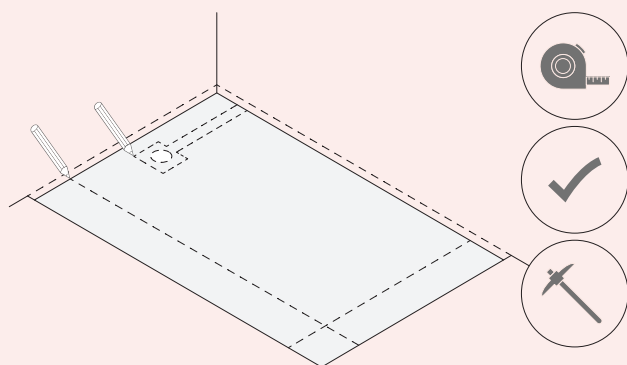

b. Once there is enough space for the installation of the drainage system, make the relevant connections to the drain pipe in the bathroom, ensuring a slope of at least 2%.

If the bathroom is already equipped with a general trap, we do not recommend installing a drainage system that includes a valve with an individual drain trap.

Once installed, make sure that the drain pipe slope is correct and check for leaks between the connections by pouring some water.

Finally, plug the drain for the next steps to prevent the outlet from clogging with construction debris.

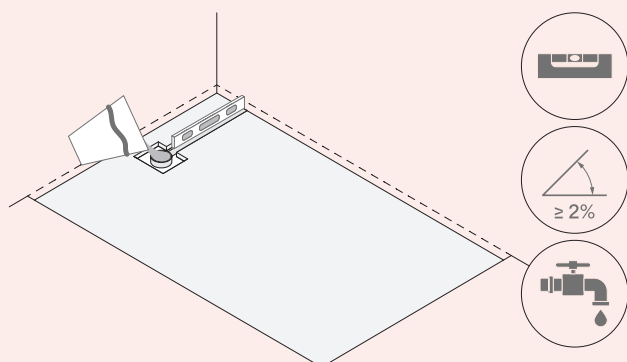

c. Make the necessary slopes towards the drainage system with mortar, using a trowel or metal screed to smooth it, and ensuring a minimum slope of 2%. Allow it to dry for at least 24 hours.

ATTENTION: This substrate must be below the finished floor level, with sufficient height to apply the waterproofing membrane, the adhesive layer and, finally, the Dekton® Grip/Grip+ tiles with the chosen thickness.

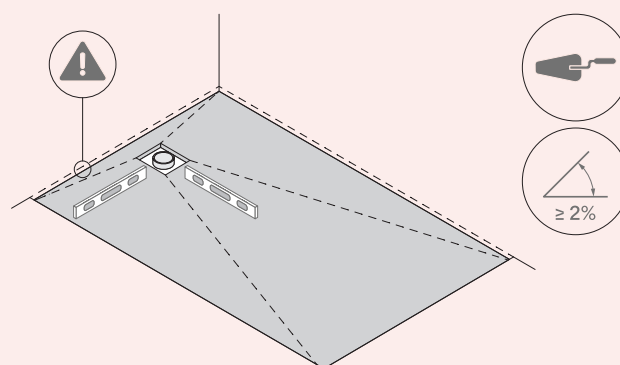

d. Place the waterproofing membrane over the substrate to ensure that it completely covers the shower area and lift it onto the adjacent walls by at least 200 mm [8"]. Once the dimensions have been checked, remove the membrane.

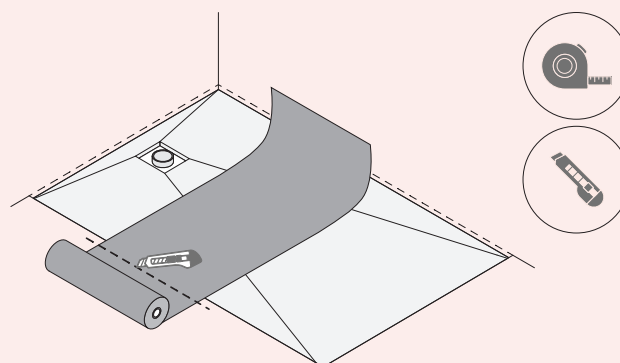

e. Prepare and apply the bi-component adhesive (class C2TE S2) uniformly, using a toothed trowel to ensure an appropriate adhesive thickness.

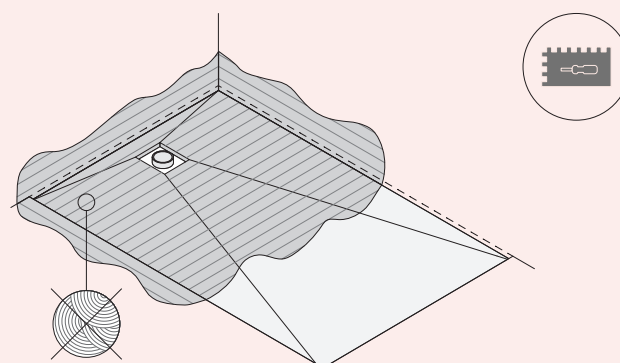

Rainfloors

Quick guide

f. Apply the waterproofing membrane, starting at the drain valve and working outwards, using a rubber trowel so that there are no wrinkles or bubbles.

At the joints with the walls, apply more adhesive with the toothed trowel and install the rest of the waterproofing membrane with the rubber trowel, from bottom to top of the wall, pressing on the edges where the horizontal and vertical planes meet to ensure good adhesion.

NOTE: It is recommended to continue waterproofing the walls in the same way, up to half height. The membrane attached to the walls must always be applied from the bottom upwards and overlapping the membrane below by at least 50 mm [2"].

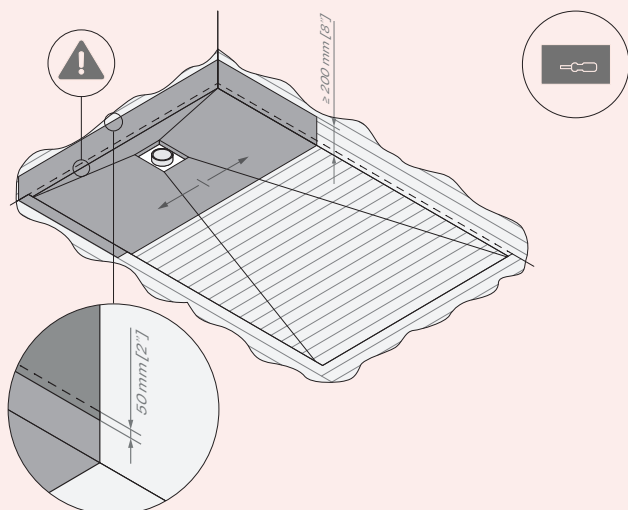

g. Prepare and spread the adhesive uniformly, both over the entire surface (ensuring that the membrane does not tear) and on the back side of the tiles, using a notched trowel.

Never apply the adhesive by spots.

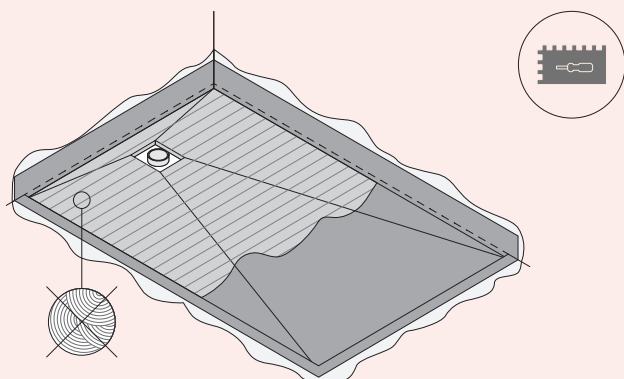

h. Install the Dekton® Grip/Grip+ tiles according to the cut for each of the slopes executed, leaving a minimum recommended joint of 2 mm [1/16"] between pieces and 4 mm [1/8"] along the perimeter against the walls. We recommend the use of spacers to maintain this joint width and leveling tools for large format tiles.

For final adjustment, press over the entire surface and make movements in both directions to ensure proper adhesion, instead of 'hammering'.

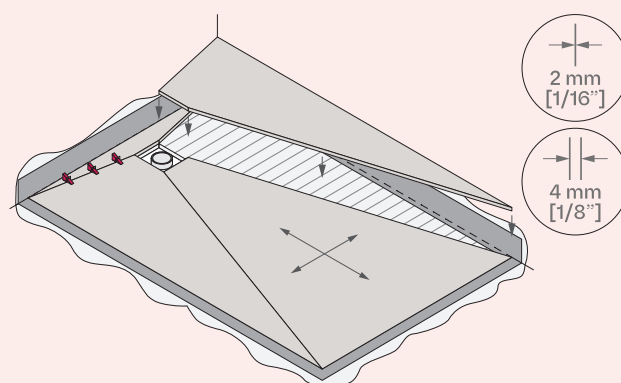

i. When filling the joints between tiles, choose the grout suitable for wet areas and the desired color and apply it as per the manufacturer's instructions. After a few minutes, wipe off any residue with a damp cloth and let it dry for at least 24 hours.

Once the grout is dry, it is important to ensure proper sealing with anti-mold silicone around the entire perimeter of the shower area in contact with the adjoining walls.

Allow to dry for at least 24 hours and fit the trim of the installed drainage system before use.

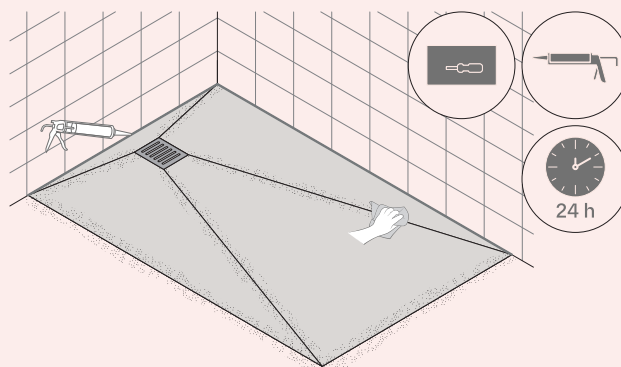

NOTE: Refer to the Dekton® Grip/Grip+ Use & Care Manual for more information on final cleaning of the job methods, regular maintenance, recommended products and restrictions for this type of material finish.