

Washbasins

Quick guide

1. Storage and unpacking

→ The washbasin must remain in its original packaging until installation.

→ When unpacking, check that the material is undamaged and that all components are available.

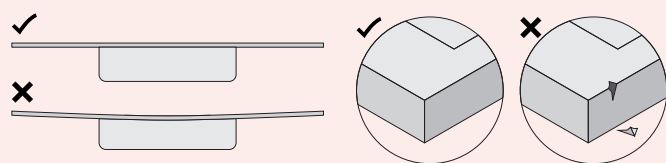

2. Wall-hung washbasin installation

NOTE: The tap and drain valve can be installed before or after the washbasin, whichever is easier.

a. Verify the outer dimensions of the washbasin and mark them on the wall at the desired height. The standard height is 800 - 900 mm [32" - 36"].

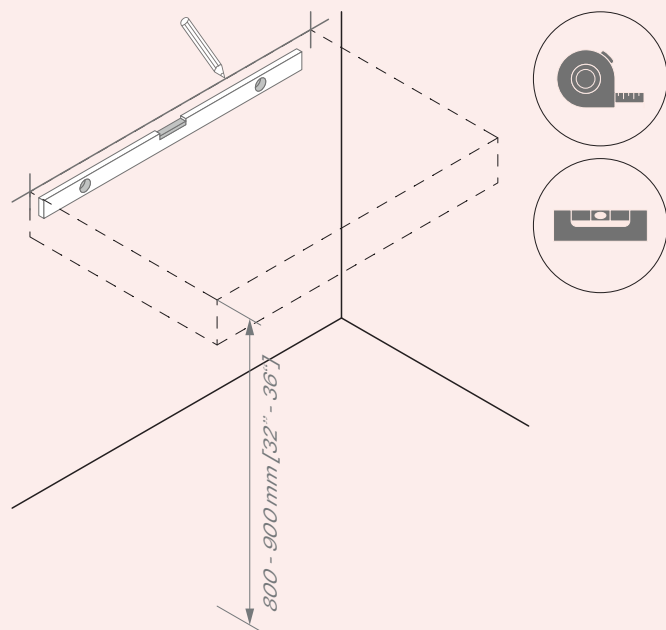

b. Install the support bars:

→ Check that the support is suitable for anchoring. If necessary, reinforce the installation.

→ Mark the location of the support bar vertically below the final height, depending on the thickness of the material (12 or 20 mm).

→ Horizontally, the distance shall be 40 - 50 mm [2"] to the skirt (if there is sufficient space) and never more than 1,200 mm [48"] between supports.

→ Screw the support bars in the desired location and check the level.

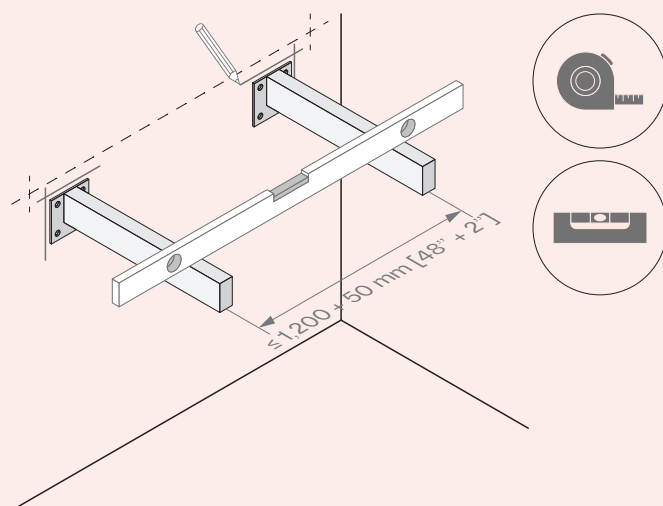

→ If the basin has a double sink, it will be necessary to place a third intermediate support bar at an equidistant position.

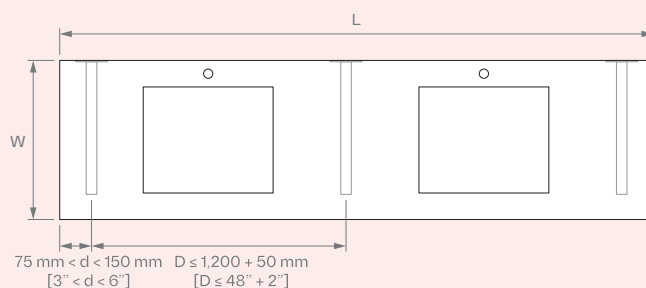

Washbasins

Quick guide

c. Before placing the washbasin, apply anti-mold silicone on the upper side of the support bars and the back edge of the worktop. A minimum joint of 3 mm [1/8"] between the washbasin and the wall should be left.

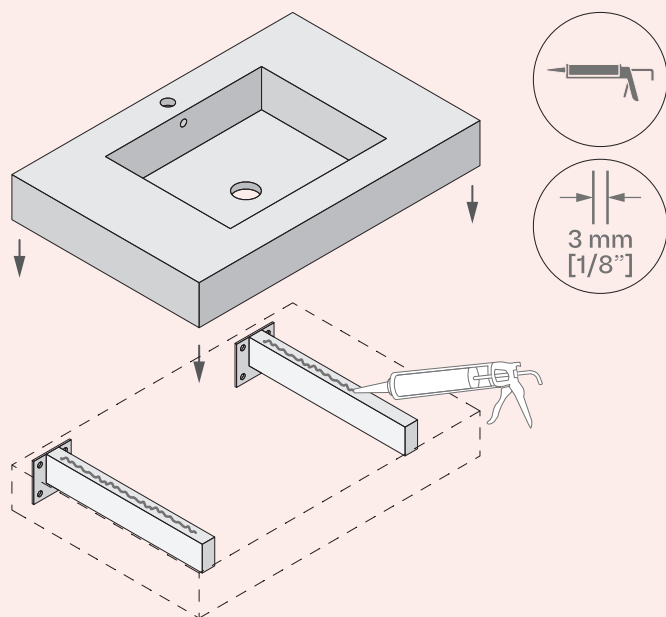

d. Immediately afterwards, place the washbasin on top of the support bars, making sure that the washbasin is centered and leveled.

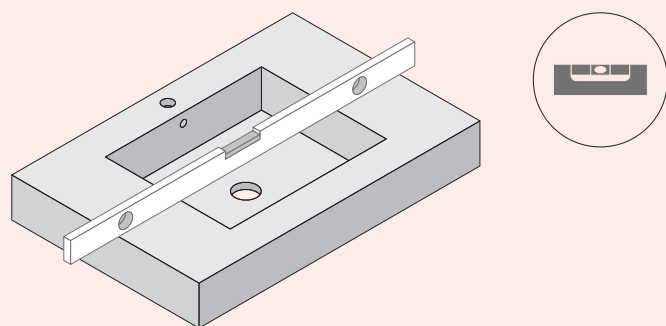

e. Clean the joint between the washbasin and the wall with a degreasing agent such as alcohol or other suitable agent. Clean the rest of the washbasin surface.

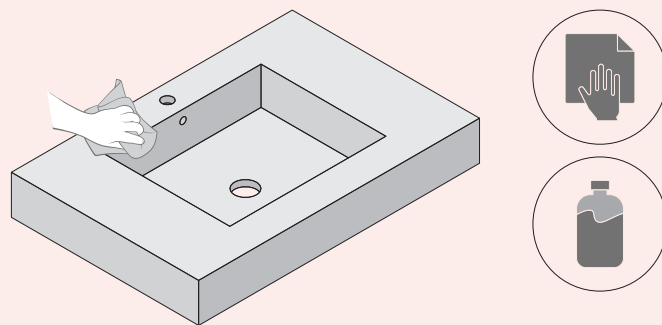

f. Seal the joint between the washbasin and the wall with anti-mold silicone. Smooth the silicone bead and let it dry for at least 24 hours.

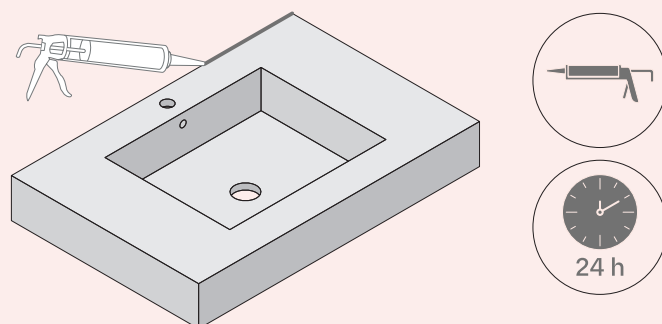

Once the installation has been completed, connect the faucet supply hoses to the wall stopcocks and the valve to the drain pipe.

NOTE: If the model includes a waterfall edge, apply also anti-mold silicone on the upper edge of it and then place the washbasin on top.

The waterfall edge **MUST NOT** support the weight of the washbasin. It is simply an aesthetic feature.

Washbasins

Quick guide

3. Washbasin installation on a bathroom cabinet

NOTE: The faucet and drain valve can be installed before or after the washbasin, whichever is easier.

a. Before placing the washbasin, apply anti-mold silicone on the upper side of the bathroom cabinet. A minimum joint of 3 mm [$1/8''$] between the washbasin and the wall should be left.

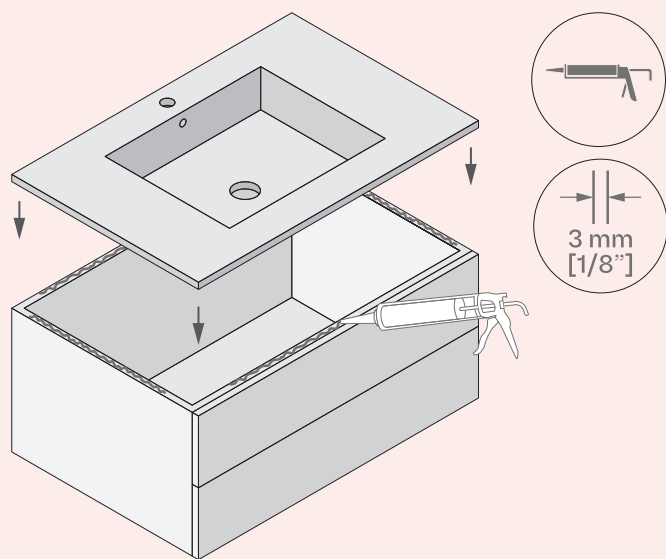

b. Immediately afterwards, place the washbasin on top of the bathroom cabinet, making sure that the washbasin is centered and leveled.

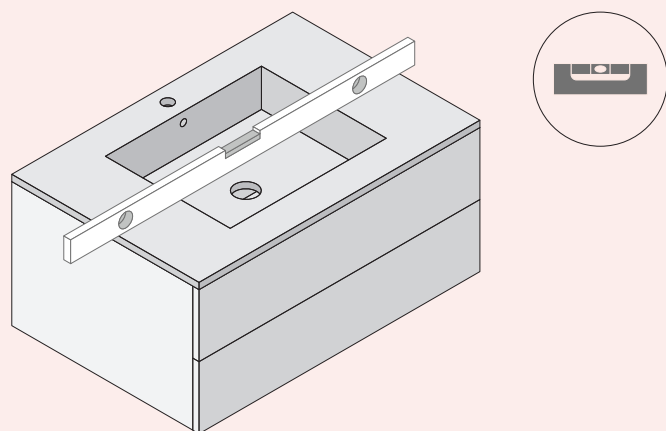

c. Clean the joint between the washbasin and the wall with a degreasing agent such as alcohol or other suitable agent. Clean the rest of the washbasin surface.

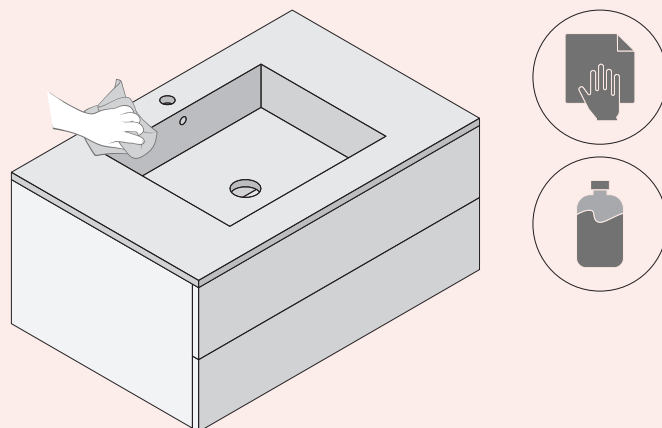

d. Seal the joint between the washbasin and the wall with anti-mold silicone. Smooth the silicone bead and let it dry for at least 24 hours.

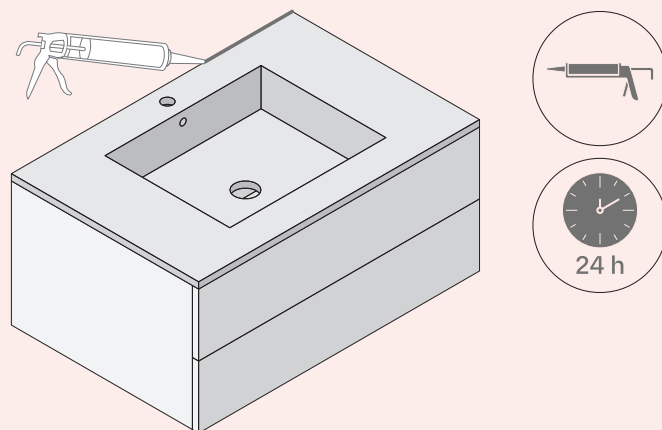

Once the installation has been completed, connect the faucet supply hoses to the wall stopcocks and the valve to the drain pipe.