

# Shower trays

## Quick guide

### 1. Storage and unpacking

- The shower tray must remain in its original packaging in a horizontal position until installation.
- When unpacking, check that the material is undamaged and that all described components are available.
- After installation, protect the shower tray with the original packaging.

### 2. Installation process

- a. Confirm the dimensions of the shower tray in its location and set the drain valve placement, checking the connection levels of the waste outlet and pipe.

Leave or open the necessary space for these elements.

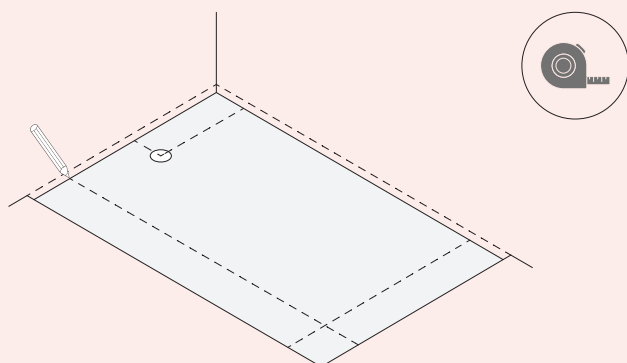

- b. In case of using a valve with side outlet, connect it to the evacuation pipe, well by thread or with an appropriate PVC adhesive, leaving a minimal slope of 2%. Check for leaks between the connections.

In case of using a valve with a vertical outlet, this step is not necessary.

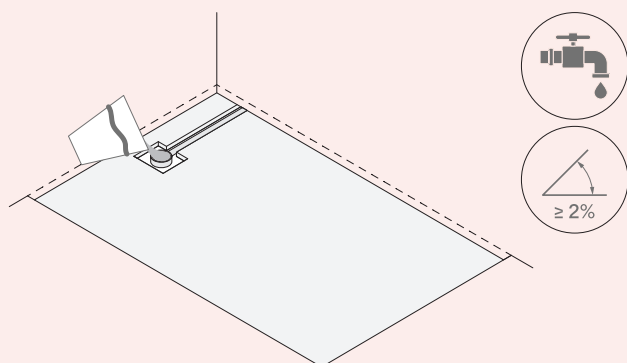

**NOTE:** It is recommended to plug the drain pipe during installation in order to prevent construction debris from falling.

- c. Prepare the substrate by making a continuous, flat and leveled surface. To do this, make a surface regulation using fast setting mortar with low shrinkage and cover the entire space. Wait until it is dry and cure before continuing the installation.

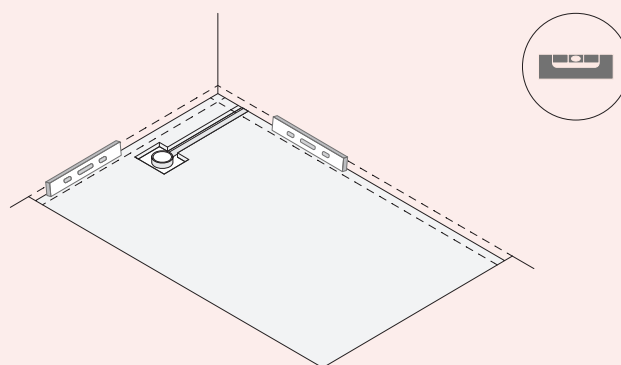

- d. Present the shower tray in its definitive position, connect the drain valve and verify the correct slope of the support, before the final gluing.

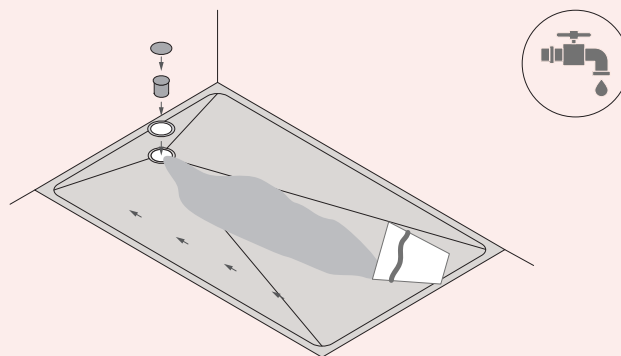

- e. Once the initial test is done, disassemble the valve and remove the shower tray to proceed with installation.

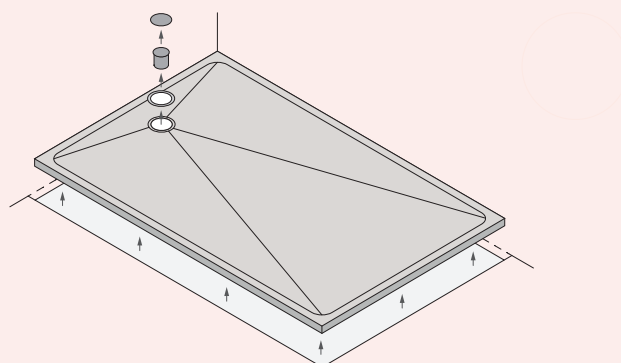

# Shower trays

## Quick guide

f. Fix the valve and pipe properly, and apply the recommended adhesive according to one of the following methods:

### → For framed shower trays

Apply different spots of two-component cementitious adhesive (class C2S2) spaced every 200 mm [8"].

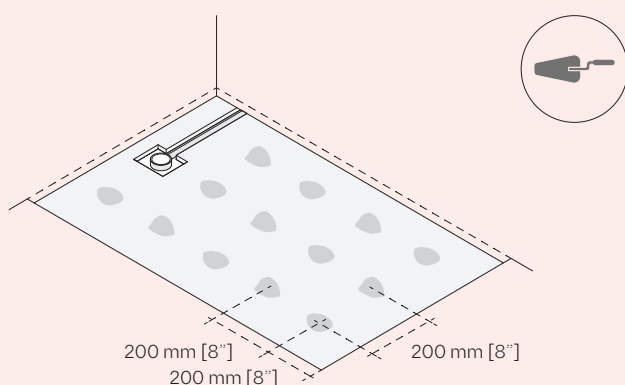

### → For flat bottom shower trays

Apply a thin-bed of two-component cementitious adhesive (class C2TE S2) using a notched trowel.

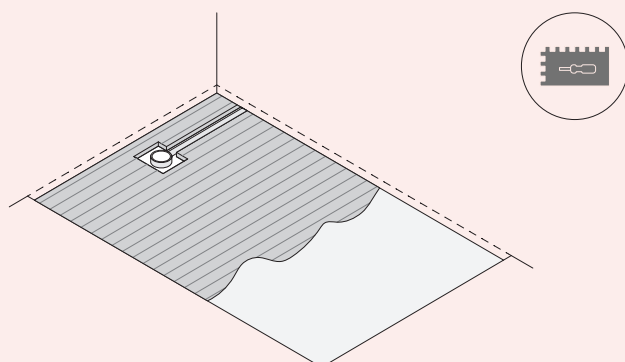

g. Then place the shower tray, leaving a minimum open joint recommended of 3 mm [1/8"] in its perimeter, and press on its entire surface.

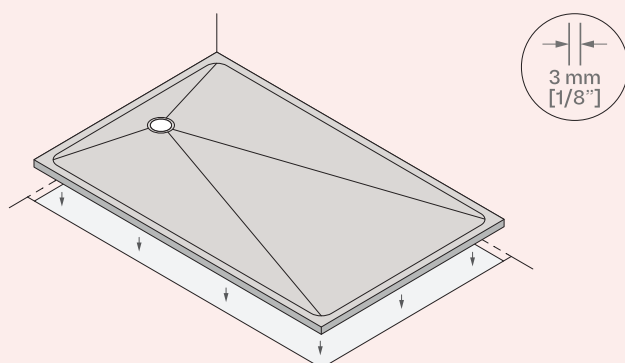

h. Install the drain valve according to the instructions supplied. It is important to do it manually (do not use electric screwdrivers).

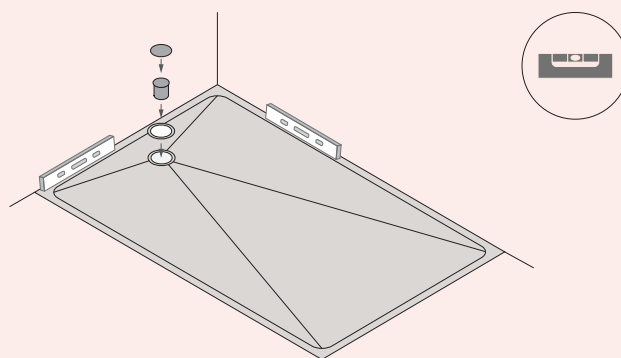

i. Verify, once again, the correct drainage of the shower tray before the adhesive dries.

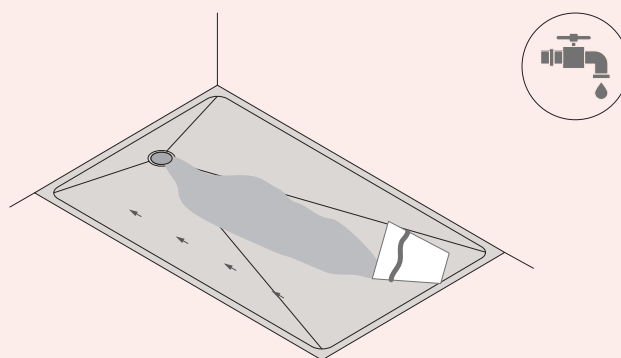

j. Once the vertical cladding and grouting have been done and it is dry, proceed with sealing the perimeter of the shower tray with anti-mold silicone. Wait at least 24 hours for the adhesive to dry and cure completely and clean up any remaining residue.

