

Cosentino Product Guide

DISCOVER ALL THE
2021-22 PRODUCTS



SILESTONE® ETHEREAL_HAZE

SILESTONE

—
DEKTON

—
SENSA

PRODUCT
CONTENT

Cosentino Product Guide

DISCOVER ALL THE
2022 PRODUCTS

SILESTONE

—

DEKTON

—

SENSA

Cosentino Product Guide

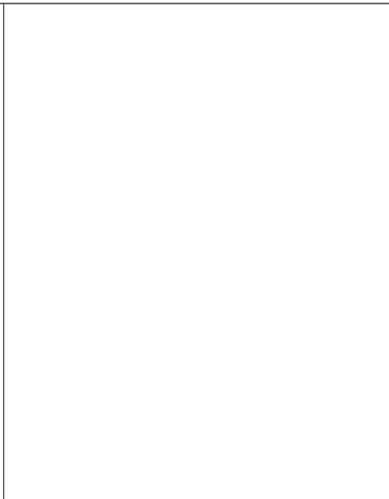

→ 6

01 COSENTINO



Certifications → 8

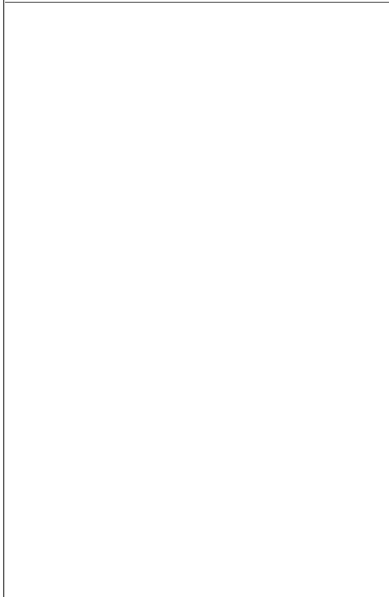
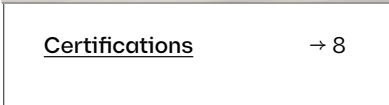

Innovative surfaces that bring the designer's vision to life throughout the home, in both indoor and outdoor spaces

→ 10

01 GET INSPIRED



Around the world → 12

→ 14

02 SUSTAINABILITY

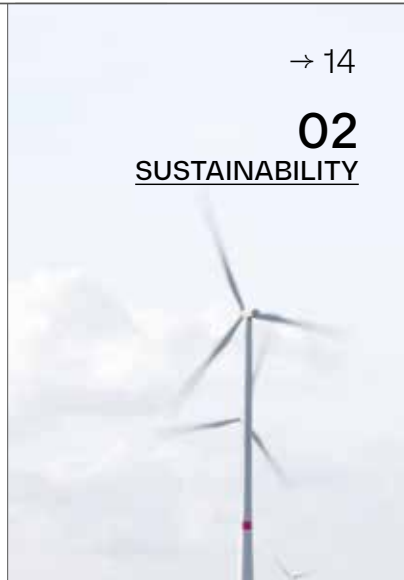

- Energy → 15
- Water → 16
- Materials → 16
- CO₂ Neutral → 18



03 PRODUCTS AND BRANDS

- Dekton® → 22
- Dekton® Slim → 24
- Dekton® Optimma → 28
- Silestone® → 34
- Sunlit Days → 40
- Ethereal → 50
- Sensa → 64
- Natural Stone → 68

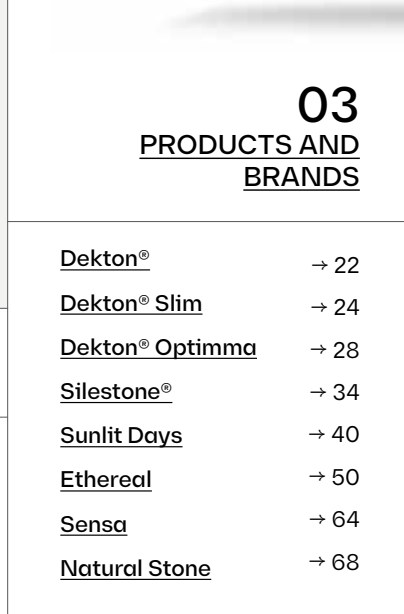

→ 70

04
SPACES



→ 72

4.1
LIVINGS



→ 78

4.2
BATHROOMS



- Sinks → 86
- Shower Trays → 90
- Vanity Tops → 87
- Flooring → 92
- HLine Bath tops → 92

→ 98

4.4
KITCHENS



Silestone Sinks → 104

→ 95

4.3
OUTDOOR



→ 106

4.5
FURNITURE





We are Cosentino

Corporate Purpose

Inspiring people
through innovative
and sustainable
spaces.

Mission

To be a leading company that responsibly imagines and anticipates, with its customers, high value and innovative surfaces for the architectural and design world.

Vision

Lead the global surfacing market by offering innovative architectural solutions that provide design, value and inspiration to our customers' lives.

Certifications

Cosentino has an unwavering commitment and respect for the environment and demonstrates this through responsible resource management, guaranteeing a commitment to innovation and continuous improvement of our processes, products, and services on a global scale.

Cosentino®

- ISO 9001
- ISO 14 001
- ISO 20 400
- UNE 15 896
- Credits in Leed and Breeam in Silestone®, Dekton® and Sensa by Cosentino®
- CSR (verified by KPMG) based on GRI - Global Reporting Initiative

Silestone®

- Declare Label
- EPD (Environdec)
- VOC (UL) Greenguard and Gold.
- VOC (Eurofins) A+
- Kosher - Countertops
- Food contact (NSF) All food contact types - Countertops
- DoC (Declaration of Conformity) in accordance with Regulations 1935/2004 / EC, 2023/2006 / EC, 10/2011 / EU - Countertops
- DoC (Declaration of Conformity) according to EN 15285, EN 15286 - Floors and coatings
- DoC Integrity (Declaration of Conformity) according to EN 13310 - Sinks

Dekton®

- Declare Label
- DGNB Label
- EPD (Environdec)
- VOC (UL) Greenguard and Gold.
- VOC (Eurofins) A+
- Chemical Spot Test (SEFA)
- Fire Safety Certification APF-1525 (Applus) based on ISO 1716
- Combustibility Test (CSIRO) based on AS 1530.1
- Fire Euroclass A1 (Tecnalia) basado en 13501-1
- Burning Characteristics (QAI) basado en ASTM E84-15bb
- DoC (Declaration of Conformity) in accordance with EN 14411 Annex G - Floors and coatings
- DoC (Declaration of Conformity) in accordance with European directive 2014/90 / EU - Boats
- UPEC 811-2.0/18 (CSTB) - Soils
- DoC (Declaration of Conformity) in accordance with ETAG 034 Article 66.3 - Facades / DoC (Declaração de Conformidade) de acordo com ETAG 034 Artigo 66.3 - Fachadas
- ETA 14/0413 - Ventilated facades
- BBA 16/5346 - Ventilated facades
- NOA 19-0227.02 - Ventilated facades
- DoC (Declaration of Conformity) in accordance with ETAG 034 Article 66.3 - Facades
- ETA 14/0413 - Ventilated facades

- BBA 16/5346 - Ventilated facades
- NOA 19-0227.02 - Ventilated facades
- Seismic Test Report T1601 (NCREE)
- Kosher - Conformidad
- Contacto Alimentario (NSF) Splash zone - Encimeras

Bathroom Collection

Sinks

- DoC (Declaration of Conformity) according to EN 14688
- CSA/IAPMO TJ5065 (QAI) based on CSA B45.5-17 / IAPMO Z124

Shower trays

- DoC (Declaration of Conformity) according to EN 1452
- Slip-Resistant TJ5148-2 (QAI) based on ASTM F462
- CSA/IAPMO TJ5148-1 (QAI) based on CSA B45.5-11 / IAPMO Z124

Sensa by Cosentino®

- VOC (UL) Greenguard and Gold.
- Food Contact (NSF) Splash zone - Countertopss

Natural Stone by Cosentino®

- DoC (Declaration of Conformity) according to EN 1341, EN 1469, EN 12057, EN 12058 - Floors and coatings



→ Cosentino City Sydney / Atelier LAB

Get Inspired







A big family around the world.

Live the Cosentino DNA
in a multifunctional space
designed to connect.

Cosentino puts a network of Cosentino Cities in over a dozen cities across the world at your disposal. Created as meeting places for inspiration and creativity, they assist interior designers and architects with finding everything they need from Cosentino.



Cosentino Global Footprint

USA

Cosentino ANAHEIM
 Cosentino ATLANTA
 Cosentino AUSTIN
 Cosentino BOSTON
 Cosentino CHARLOTTE
 Cosentino CHICAGO
 Cosentino CINCINNATI
 Cosentino DALLAS
 Cosentino DENVER
 Cosentino DETROIT
 Cosentino FORT LAUDERDALE
 Cosentino HAWAII
 Cosentino HOUSTON
 Cosentino KANSAS CITY
 Cosentino LONG ISLAND
 Cosentino LOS ANGELES
 Cosentino MILWAUKEE
 Cosentino MINNEAPOLIS
 Cosentino NASHVILLE
 Cosentino NEW JERSEY
 Cosentino NEW ORLEANS
 Cosentino ORLAND
 Cosentino PHILADELPHIA
 Cosentino PHOENIX
 Cosentino PITTSBURG
 Cosentino PORTLAND
 Cosentino PUERTO RICO
 Cosentino RALEIGH
 Cosentino ROCHESTER
 Cosentino SACRAMENTO
 Cosentino ST. LOUIS
 Cosentino SALT LAKE CITY
 Cosentino SAN DIEGO
 Cosentino SAN FRANCISCO
 Cosentino SEATTLE
 Cosentino SPOKANE
 Cosentino TAMPA
 Cosentino VIRGINIA
 Cosentino WASHINGTON DC
 Cosentino CITY LOS ANGELES
 Cosentino CITY MANHATTAN
 Cosentino CITY MIAMI
 Cosentino CITY SAN FRANCISCO
 Cosentino HUB HOUSTON
 Cosentino HUB NORFOLK

CANADA

Cosentino CALGARY CANADA
 Cosentino CALGARY

 Cosentino QUEBEC
 Cosentino TORONTO
 Cosentino VANCOUVER
 Cosentino CITY MONTREAL
 Cosentino CITY TORONTO

LATAM

Cosentino MEXICO DF

MALAYSIA

Cosentino KUALA LUMPUR

SPAIN

Cosentino A CORUÑA
 Cosentino ALMERÍA
 Cosentino BARCELONA
 Cosentino BILBAO
 Cosentino CASTELLÓN
 Cosentino GIRONA
 Cosentino GRANADA
 Cosentino MADRID
 Cosentino MÉRIDA
 Cosentino MURCIA
 Cosentino SAN SEBASTIAN
 Cosentino SANTANDER
 Cosentino SEVILLA
 Cosentino TOLEDO
 Cosentino VALENCIA
 Cosentino VALLADOLID
 Cosentino VIGO
 Cosentino CITY BARCELONA
 Cosentino CITY MADRID

PORTUGAL

Cosentino LISBOA
 Cosentino PORTO

BRASIL

Cosentino FORTALEZA
 Cosentino GOIÂNIA
 Cosentino LATINA VITORIA
 Cosentino RÉCIFE
 Cosentino SANTA CATARINA
 Cosentino SAO PAULO IRELAND

IRELAND

Cosentino DUBLIN

UK

Cosentino BELFAST
 Cosentino DARLINGTON
 Cosentino EAST LONDON
 Cosentino GLOUCESTER
 Cosentino HOOK
 Cosentino MANCHESTER
 Cosentino NEWMARKET
 Cosentino SCOTLAND
 Cosentino CITY LONDON

DENMARK

Cosentino DENMARK

FINLAND

Cosentino HELSINKI

GERMANY

Cosentino BERLIN
 Cosentino DÜSSELDORF
 Cosentino MÜNCHEN
 Cosentino STUTTGART

ITALY

Cosentino CATTOLICA
 Cosentino LAZIO
 Cosentino MILANO
 Cosentino TORINO
 Cosentino TURÍN
 Cosentino VENEZIA
 Cosentino CITY MILANO

FRANCE

Cosentino LYON
 Cosentino MARSEILLE
 Cosentino PARIS
 Cosentino RENNES
 Cosentino STRASBOURG
 Cosentino TOULOUSE

AUSTRIA

Cosentino WEIN

BELGIUM

Cosentino BELGIUM

NORWAY

Cosentino OSLO

SWEDEN

Cosentino GÖTEBORG
 Cosentino STOCKHOLM

SWITZERLAND

Cosentino ZÜRICH

HOLLAND

Cosentino THE NETHERLANDS

ISRAEL

Cosentino CAESAREA
 Cosentino TEL AVIV

TURKEY

Cosentino ANKARA
 Cosentino ISTAMBUL
 Cosentino IZMIR

SINGAPORE

Cosentino SINGAPORE
 Cosentino CITY SINGAPORE

AUSTRALIA

Cosentino ADELAIDE
 Cosentino BRISBANE
 Cosentino MELBOURNE NORTH
 Cosentino MELBOURNE SOUTH
 Cosentino PERTH
 Cosentino SYDNEY
 Cosentino CITY SYDNEY
 Cosentino HUB SYDNEY

NEW ZEALAND

Cosentino AUCKLAND
 Cosentino LO CHRISTCHURCH

JAPAN

Cosentino LO TOKIO

SOUTH AFRICA

Cosentino JOHANNESBURG
 Cosentino LO CAPE TOWN

UAE

Cosentino LO DUBAI
 Cosentino CITY DUBAI

POLAND

Cosentino WARSAW

Cosentino Sustainability

At Cosentino, we approach sustainability as a collective commitment that stems from the individual involvement of those that are a part of Cosentino.

Our continuous improvement efforts involve constant analysis of our entire value chain - from the acquisition of raw materials to the delivery of the final product to consumers.

We are firmly aligned with the United Nations' 2030 Agenda. As a global leader in the manufacturing and distribution of innovative surfaces from our headquarters in Almeria, Spain, we are committed to driving the path towards local and global sustainability.

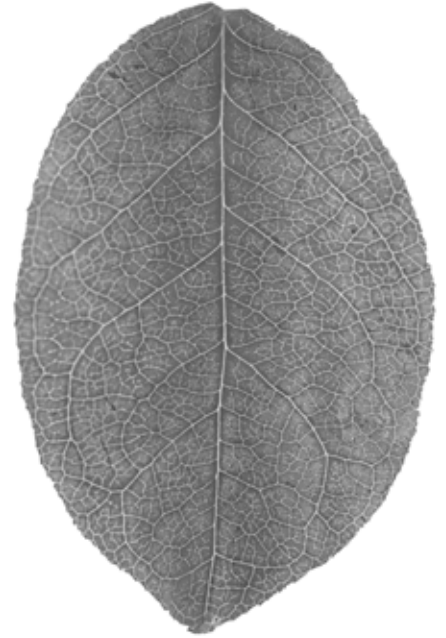

→ Olive trees in the Cosentino industrial park



→ LED lighting throughout the Cosentino industrial park



→ Photovoltaic installations at Cosentino

Energy

Energy efficiency and the use of renewable energy sources are the two core elements of our strategy to minimize the impact of our activities.

100% of our energy consumption comes from renewable energy sources, and we aspire to reach 30% energy self-consumption in the coming years.

On the other hand, the constant improvement of our processes and machinery allows us to reach a high level of energy efficiency, which translates into an 8% decrease of our electrical consumption in our production processes.



Water

Since our inception, we have valued the importance and understood the challenges of proper water management.

It has motivated us to implement a sustainable use policy maximizing the efficient use of water resources in the different production processes.

We use cutting-edge technology to achieve 99% recycled water in all our processes in the Cosentino Industrial Park.

In addition, we use 100% of the surplus water to irrigate green areas.



Materials

We are committed to making the most of the materials we work with throughout the value chain.

In recent years we embarked on an ambitious R&D project called “Circularity” to reuse the materials from which our products are made.

Another action is the innovative HybriQ+ technology that brings about the new generation of Silestone. HybriQ+ incorporates a minimum of 20% recycled materials and is manufactured with 100% renewable energy and 99% recycled water.

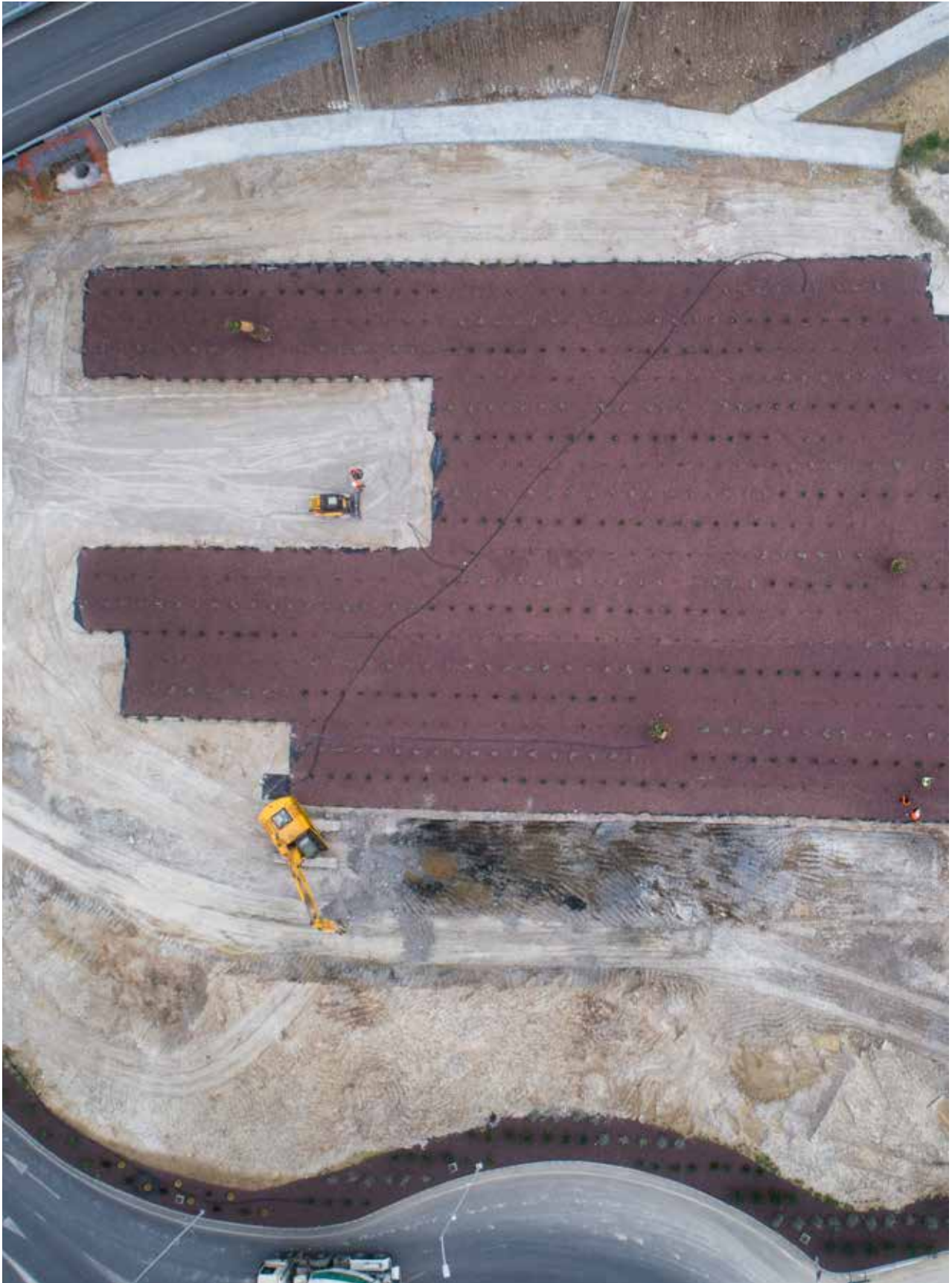

Carbon neutrality: Sustainable design

Cosentino Group is deeply committed to sustainable development in the company's growth strategy, prioritizing respect and protection of the environment.

We address aspects related to the efficient use of natural resources, proper waste management, atmospheric emissions, discharges



We calculate our carbon footprint

It is an external body that verifies the calculation and the results of the carbon footprint that is submitted to the Spanish Ministry for Ecological Transition and Demographic Challenge (MITECO, in Spanish), which is responsible for approving and registering our footprint, becoming part of the **'Spanish registry of carbon footprint, offsetting and carbon dioxide absorption projects'** of the Spanish Climate Change Office (OECC, in Spanish), whose results are made public as an exercise in transparency.

This calculation uses energy and/or fuel consumption data, as well as raw material consumption data collected from all **Group subsidiaries** (Centres, Workshops, Cities, HUBs, HQ, etc.) with a view to offset these emissions.

and other potential impacts in order to make sustainable use of natural resources and protect biodiversity and ecosystems.

At Cosentino we are strongly committed to the 2030 Agenda promoted by the United Nations and the Local Action Plan promoted by the Spanish Government.

As a demonstration of our commitment, we have managed to offset the 42,532 tons of CO₂ emissions resulting from one year of Dekton® production, thus obtaining



We reduce our impact

We are committed to energy efficiency, emissions reduction and sustainable mobility to minimize our impact.

- **Energy efficiency:** it is a priority for Cosentino to reduce energy consumption in the production process and in the general group activity, which is why we have managed to obtain 100% of the electricity we use from renewable sources.
- **Emission reduction:** 2.8 million euros have been invested in the implementation of an energy management and monitoring system for the heat systems, which allows heat from the Dekton® furnaces to be recovered and used in the dryers, thus reducing emissions.
- **Sustainable mobility:** we have recently joined the 'Plan Sumamos Salud + Economía' under which we have a Mobility Policy that helped us to avoid 230 TCO₂ in 2018.

the Zero Carbon Footprint label for the entire product life cycle in 2019 for all Dekton® products.

In addition, the Sunlit Days series by Silestone® is the brand's first collection to achieve the carbon neutral certification.



We offset our emissions

To achieve carbon neutrality in Dekton®, at Cosentino **we offset our emissions over the entire product life cycle** (scopes 1+2+3) by investing in GHG emission reduction projects.

For this purpose, we identify those projects that meet the requirements for responsible offsetting and that, in turn, have a strong social dimension that contribute to the achievement of the **Sustainable Development Goals of the UN's 2030 Agenda**.

The project selected to offset the 42,532 tons of CO₂ emissions, resulting from one year of Dekton® production, has a direct impact on sustainable development by **supporting the local economy, providing training and job opportunities**.



HybriQ Technology



99%
Recycled
Water



0%
Water
Discharge



100%
Renewable
Electric Energy



Min. 20%
Recycled
Materials

The Ultimate Mineral HybriQ Surface: Silestone®

An innovative generation of surfaces made entirely with renewable energy, 99% recycled water and a hybrid formulation composed of a high-performance blend of premium minerals, quartz, and recycled materials, such as glass. More beautiful. More innovative. More sustainable.



More innovation. Same performance

Commitment to innovation and sustainability leads Silestone® to exceptional performance and amazing color depth. With the same quality and warranty that has made us industry leaders.

More design possibilities

The new composition of premium minerals selected worldwide for each design allows for a greater depth of Silestone® colors, textures and shades in order to create unique and personalized spaces.

More sustainability

HybriQ+® uses a minimum of 20% recycled materials in its composition, such as glass, and its manufacturing process is powered entirely by renewable energy and recycled water.

Dekton®

by Cosentino®



DEKTON®
designed by **COSENTINO**

Innovative design.

Dekton® is a sophisticated blend of over 20 minerals extracted from nature. Its production process is the result of years of research, development, and innovation in the manufacturing of glass, state-of-the-art porcelain and quartz surfaces.

Electron microscopy makes it possible to appreciate the reduced porosity of the material, a consequence of the sintering and ultracompaction process exclusive to Dekton®. This reduced porosity and the absence of micro-defects causing stresses or weak points are the distinguishing features of Dekton®.



Sintered Particle Technology

Dekton® uses an exclusive SPT in its manufacturing, capable of sintering mineral particles, bonding them together and compacting their internal structure. This innovative technological process mimics and accelerates the processes that natural stone undergoes when exposed to high pressures and temperatures for millenia.

Dekton® emulates in a few hours what nature takes millennia to do, thanks to the exclusive SPT technology.

- The furnace has a length of 180 meters.
- Temperatures reach approximately 1250°C.
- Total processing time depends on the thickness of the slab (about 4 hours).

Safety in facades and cladding

In order to reinforce safety in ventilated facades and interior cladding, there is the possibility of adhering a safety mesh behind the Dekton® slab, specially developed to prevent falls due to breakage. It is a 300 g/m² fiberglass mesh adhered to the material with epoxy resin. Safety is one of Cosentino's main concerns.



1

Compacted Mineral



2

Mineral Crystallization

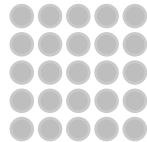

3

Crystalline network

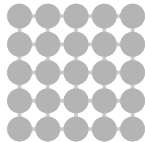

4

Network liquidation

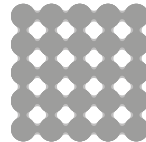

5

Solidification of the liquid

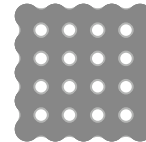

6

Ultracompact slab



1200 °C

25 °C



Press

Oven

Ultracompact Surface

Dekton® features

Dekton® Product features

Dekton® has all the technical specifications required in a high resistance surface to materialize any interior and exterior residential or commercial design project.



Low water absorption

Dekton®'s water absorption is negligible so it does not undergo any expansion movement due to it.



Highly resistant to ultraviolet (UV) light

Dekton® is highly resistant to UV light and will not fade or degrade over time in any kind of outdoor application.



Superior mechanical resistance

Dekton®'s variety of thicknesses allow it to be used in applications where resistance to wind or impact are a project requirement.



Fireproof material

Dekton® can withstand high temperatures without burning, scorching or cracking. European Standard EN 13501 and ASTM E84 testing classifies Dekton® as a noncombustible material.



Color durability

Dekton®'s control of pigmentation and decoration in the manufacturing process provides better color consistency from one slab to another, resulting in a long lasting product that will not fade over time.



Scratch resistant

Dekton® is one of the most scratch resistant surfaces on the market today. It has a rating of seven (7/10) on the Mohs scale for mineral hardness.



Dimensional stability

Dekton® expansion is minimal so it can be installed with thin joints between panels. These joints will keep their width in all conditions.



Resistance to freezing and thawing

Dekton®'s resistance to durability tests in freezing and thawing situations and its application in various weather conditions prove its high performance.



Abrasion resistant

Dekton® is even more resistant to abrasion than granite and porcelain, making it the ideal surface for facades or high-traffic flooring in commercial applications.



Maximum fire and heat resistance

Dekton® has been successfully installed on facades in areas exposed to high temperatures.



Easy cleaning and low maintenance

Most graffiti can be removed from Dekton® with standard cleaning products. Maintenance costs are reduced.



Stain resistant

Dekton® is resistant to stains from a variety of sources so they can easily be removed without altering the surface's finish.

Dekton® Slim

DEKTON® SLIM
designed by COSENTINO

High aesthetic value and performance
in vertical cladding and furnishings.

Minimum Thickness of 4mm → Large Format & Performance

Dekton® Slim is the ultra-thin 4mm thickness in large format that offers unlimited design options and incredible ease of installation and transportation. It's ideal for bathroom and kitchen floors and walls, as well as all types of furniture.

01 → Large format and minimum number of joints

Its large format of up to 126" x 56" covers large surfaces, minimizing the number of joints and therefore, dirt.

02 → Easy Installation

Having such a light format, but with so many possibilities, simplifies everything. Its thin thickness allows for quick cutting and on-site adjustments with ceramic tile tools.

03 → Design without limits

Dekton® Slim is very easy to work with and can be cut to size. It adapts to all spaces.

04 → Maximum resistance to humidity

Dekton® Slim is the ideal ultra moisture and stain resistant coating for bathrooms. A high performance product that requires no more maintenance than a simple damp cloth.

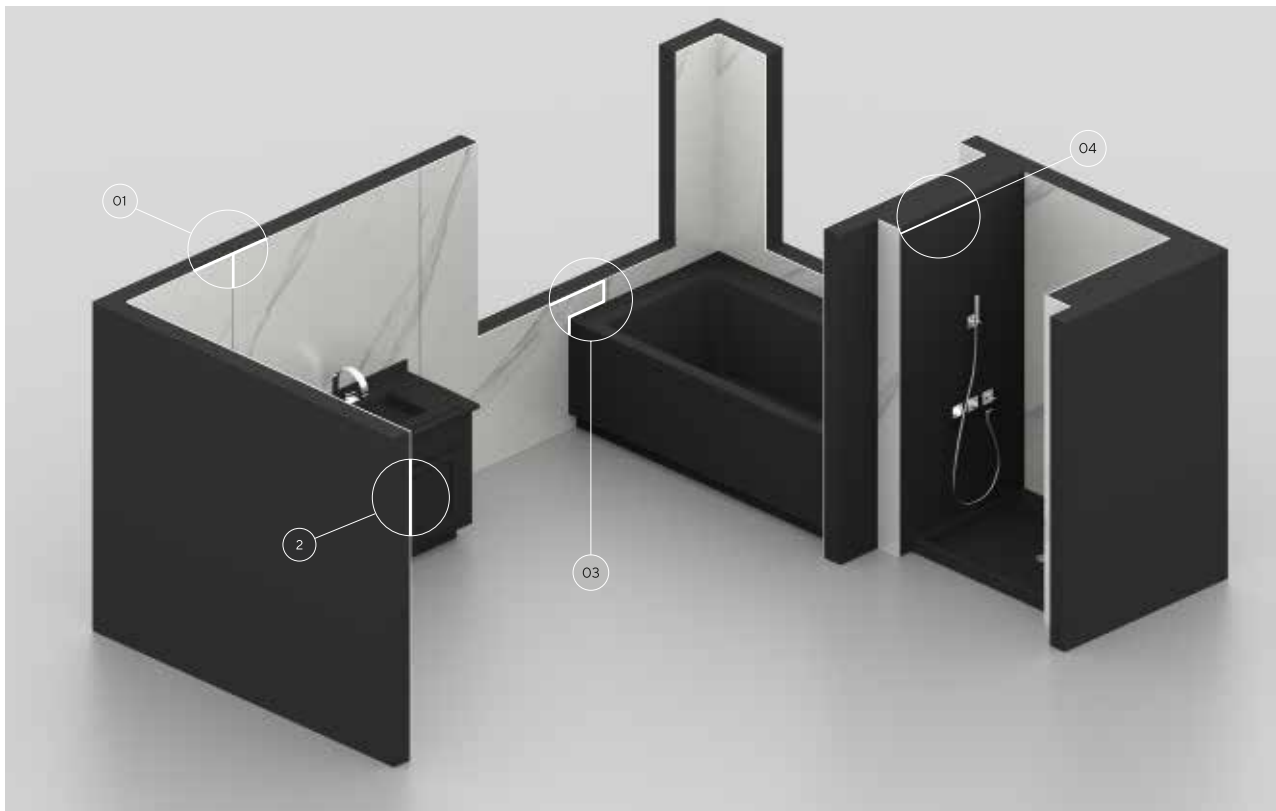

Dekton® Formats

Adaptable and
versatile.
In any space.

Dekton® offers a variety of standard sizes, custom sizes and thicknesses to meet the functional and creative needs of the designer in any interior or exterior project, no matter how complex.



Large format

Optimma Format → 260 x 100 cm
Large format Slab → 320 x 144 cm

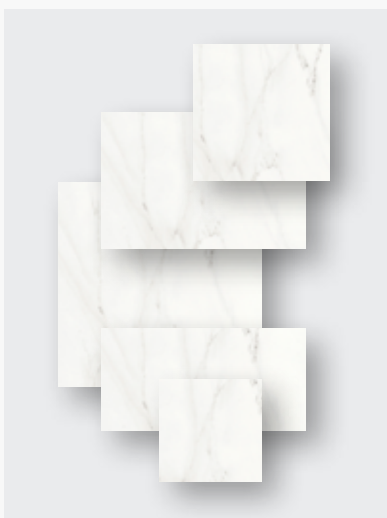

Other formats

- 106 x 71 cm
- 142 x 106 cm
- 142 x 106 cm
- 142 x 142 cm
- 142 x 71 cm
- 142 x 79 cm
- 159 x 142 cm
- 159 x 71 cm
- 71 x 71 cm
- Custom formats



Thicknesses

- 0.4 cm
- 0.8 cm
- 1.2 cm
- 2 cm
- 3cm

Dekton® textures

Dekton® comes in different textures so that the only limit is the imagination: from the ultra-glossy finish, to matte or velvet textured options.

Different Sensations.
Richness of Shades.



X-Gloss

A luminous and dazzling finish achieved by mechanical polishing, without the need for enamels or other materials.



Matte

The matte texture pursues a natural, shine-free appearance, ideal for achieving a harmonious and timeless finish. Most Dekton® products are manufactured with this finish.



Velvet

The materials chosen in Velvet create a feeling of warmth and comfort. This texture is perfect in classic colors with veins.



Matte or Textured Velvet

Matte or Textured Velvet textures combine the warmth of velvet with the roughness of a textured, imperfect material. They are ideal for emulating the finish of natural stone.

Optimma

New optimized Dekton® format.

The ultimate interior cladding solution.

The Dekton® slab has been optimized with its most common applications in mind to create a new format with improved cost, design, installation and handling. Introducing our first Optimma family format specifically for cladding:

Optimma format :
260 x 100 x 0,4 cm.



260x 100 cm In 4 mm thickness

The slabs are created in 4mm thickness, which gives it a lightness that allows easy handling, and in case of need, it can be easily cut to adapt the product to all spaces.



Cost Efficiency

The sizes are optimized to the most common cladding standards, allowing us to avoid waste, which in turn reduces price.



Design with Purpose

The slab has been created to take advantage of its total height, which makes it much easier to cut it for cladding.



Easy to Install

The product is smaller and lighter, which makes it easier to use, transport and handle. Cutting can be done with simple tools. The edges are already bevelled and the piece is always meshed.



Design Match

The design has been conceived to place the boards vertically to create a continuous design.



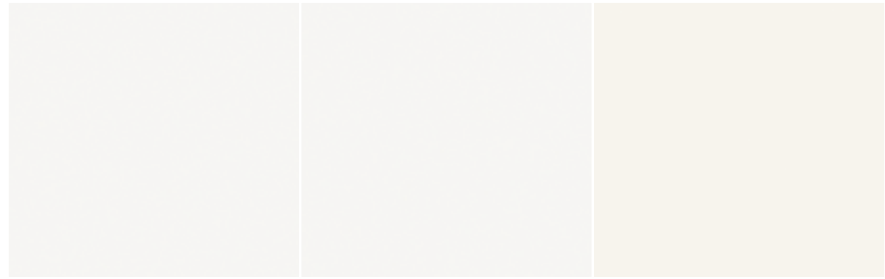

Uyuni

Zenith

Halo

Mooné



Tundra 19

Aura 15

Rem

Natura 18



Opera

Olimpo

Helena

Kairos



Entzo

Sky

Nilium

Bergen

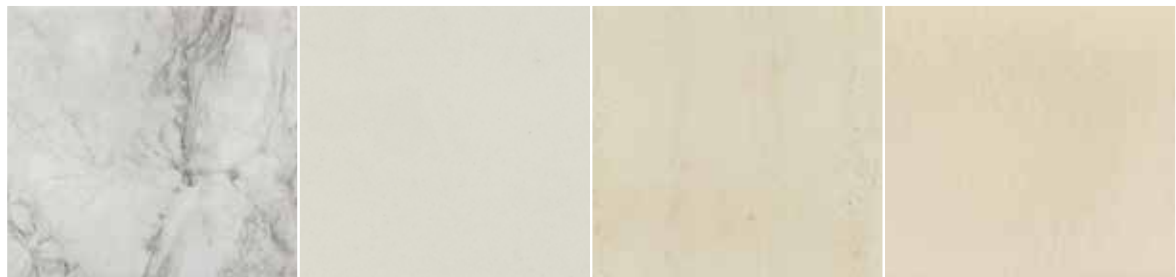

Portum

Aeris

Danae

Edora



Sasea

Arga

Taga

Keon



Kovik

Strato

Sirocco

Khalo



Kreta

Soke

Vera

Orix



Kira

Trilium

Keranium

Radium

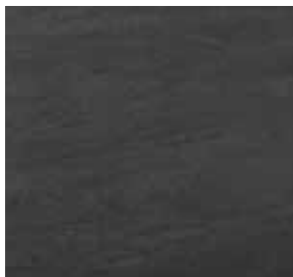

Bromo

Dekton Collection

GROUP 0

AERIS	☐ ✎ 4
DANAE	☐ ✎
ETER	☐ ✎ 4
KEON	☐ ✎
SIROCCO	☐ ✎ 4
STRATO	☐ ✎ 4

GROUP 1

BROMO	☐ ✎ 4
EDORA	☐ ✎ 4
FOSSIL	☐
KERANIUM	☐
MOONÉ	☐ ✎ 4
SASEA	☐ ✎ 4
SIRIUS	☐ ✎ 4

GROUP 2

DOMOOS	☐
GALEMA	☐
KAIROS	☐
KELYA	☐ 4
KIRA	☐ ✎
KOVIK	☐ 4
KRETA	☐ ✎ 4
LAOS	☐ ✎ 4
LUNA	☐ ✎ 4
NILIUM	☐ ✎
ORIX	☐ ✎
PORTUM	☐
RADIUM	☐
SOKE	☐ ✎
TRILIUM	☐ ✎ 4
VERA	☐ ✎
ZENITH	☐ 4

GROUP 3

AURA 15	☐ ✎ 4
ENTZO	☐
LAURENT	☐ ✎ 4
OPERA	☐ 4
REM	☐ ✎ 4
UYUNI	☐

GROUP 4

AURA 15 BOOKMATCH	☐ 4
----------------------	-----

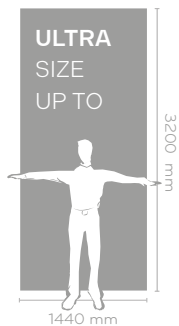

Due to its intense shine, X-Gloss requires special maintenance and care, particularly with the darker shades, where its intense color can reveal small details. The provided samples don't guarantee that the supply will be absolutely identical in tone and veins. See General Conditions of Sale.

✎ POLISHED

☐ SMOOTH MATTE FINISH

☐ TEXTURED FINISH

☐ VELVET

☐ DEKTON GRIP+, THE ANTI-SLIP SOLUTION FOR WET AREAS

4 DEKTON SLIM 4MM

Dekton X-Gloss Collection

GROUP 3

NATURA 18



TUNDRA 19



GROUP 4

ARGA



BERGEN



HALO



HELENA



KHALO



NATURA 18 BOOKMATCH



OLIMPO



TAGA



The Grip + treatment is only recommended for flooring with special antislip requirements.

The thickness 4mm is served in units of 10 or 25 slabs.

The material will be served from Cosentino Central HQ, see delivery terms.



Silestone®

by Cosentino

The Ultimate Mineral HybriQ Surface

Silestone® is a hybrid surface of premium minerals, quartz, and recycled materials to dress interior spaces with color and texture.

Silestone® advantages.

Silestone® is extremely durable in kitchens, bathrooms and other spaces exposed to constant activity and use. In addition, it offers an unlimited range of colors and textures.

Silestone® has many advantages, including minimal maintenance, high resistance to stains and scratches, and a low fluid absorption rate. This resistance to fluids and its minimal joints make Silestone® the ideal solution for places where liquids are present. Silestone® is resistant and allows for prolonged enjoyment to last a lifetime.

The properties of Silestone® are the result of constant years of innovation that guarantee maximum hygiene and safety.



Acid and Scratch Resistant

Silestone® has a high level of scratch and impact resistance, as well as resistance to external aggressors such as acids common in daily kitchen use.

Impact Resistant

The high impact resistance of Silestone® allows the handling of hard objects (pots, pans, trays, etc.) with total peace of mind.

Stain Resistance

Silestone® is a non-porous surface that is highly resistant to stains from coffee, wine, lemon juice, oil, vinegar, makeup and many other everyday products.





Silestone® with HybriQ+ Technology®

HybriQ is a pioneering technology from Silestone®. An innovative generation of surfaces composed from a hybrid formulation. A new high-performance blend of premium minerals, quartz and recycled materials.

The result is a more beautiful and sustainable product. Silestone with HybriQ Technology is made through a manufacturing process completely fueled by renewable energy and recycled water. This new generation maintains the guaranteed quality and warranty of Silestone.

More innovation

Cosentino®'s commitment to offering the most innovative and sustainable surfaces leads Silestone® to exceptional performance and depth of surprising color. Silestone® is the combination of innovation and sustainability.

More sustainable

HybriQ+ uses a minimum of 20% recycled materials, 99% recycled water and 100% renewable energy.

This new generation of surfaces maintains the 25-year Silestone® warranty.

More design

The new mineral composition allows for greater depth of color, textures and Silestone® tones to create unique and personalized interior spaces.

Same benefits

Silestone® with HybriQ+ maintains all the characteristics of quality, durability and warranty that have made Silestone® the market reference in its category.

HYBRIQ+
TECHNOLOGY

Silestone® Formats

Infinite possibilities for
indoor applications.

Silestone® is available in slabs up to 325x159cm and in 30x30cm, 40x40cm, 60x60cm, 60x30cm and 60x40cm tiles. They are marketed in thicknesses of 1.2, 2 and 3cm. In addition, different pieces can be combined to simulate thicker edges.



Large format

Jumbo Slab → 325 x 159 cm
Standard Slab → 306 x 140 cm

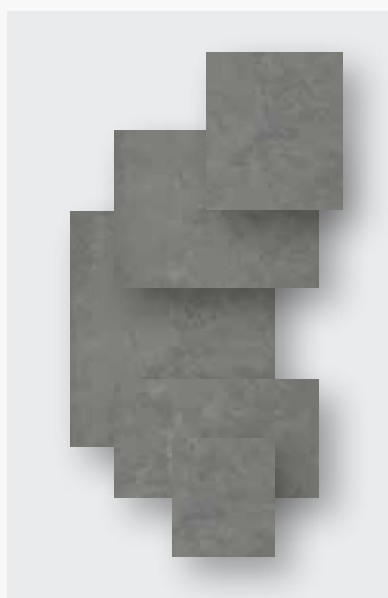

Floor formats

- 30 x 30 cm
- 40 x 40 cm
- 60 x 60 cm
- 60 x 30 cm
- 60 x 40 cm
- Custom Size



Thicknesses

- 1.2 cm
- 2 cm
- 3 cm
- Custom thicknesses adding different pieces

Jumbo Slabs

Cosentino® offers Silestone slabs in Jumbo format (325x159cms max.). This format allows for the creation of large surfaces with minimal jointing, design versatility, and better hygiene. This way, the slabs' use is optimized and waste minimized.

Silestone® textures

Surface sensory
perception.

In order to adapt to all styles, Silestone® offers different textures for any of its applications. Polished, Suede or Volcano are three possibilities that make the imagination soar and bring to life countertops, floors or walls with the desired texture.



Polished

Extreme shine, a smooth surface to the touch and a uniform, intense and consistent color.



Suede

Extra matte finish, offers a flat, non-rugged surface, which conveys a unique experience to the touch for its beauty and fineness.



Volcano

Rustic texture, rough to the touch, but soft at the same time, an attractive and pleasant to the touch surface

Edges 3/4"



Bullnose



Half Bullnose



1/4 Rund polerad



Basic / Eased

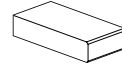

Basic / Eased



Ogee

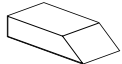

Shark Nose



Shark Nose

Edges 1-1/4"



Bullnose



Demi-Bullnose

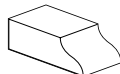

Ogee

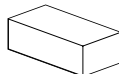

Ogee

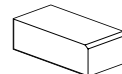

Bevel Xmm

Edges 1-1/2"

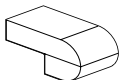

Bullnose / *

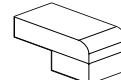

Demi Bullnose/i



Ogee

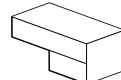

Basic / Eased

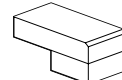

Bevel Xmm

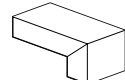

Mitered

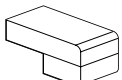

Waterfall



Ogee Bullnose

Other edges

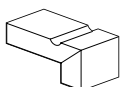

Edge 45° + Mitred
bevelled edge 45%

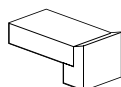

Antidropp-kant

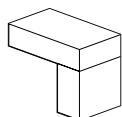

Polished straight edge
+ Non-bevelled planed
section

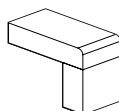

1/4 Bullnose and Non-
bevelled planed section

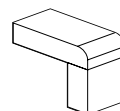

1/2 Bullnose and
non-bevelled
planed section

Edges

Customized cutting and polishing processes can be used for Silestone®, creating edges of all types. This section details some of the most popular ones, but the possibilities are limitless.



Mediterranean Color Shades

New Sunlit Days Collection

Sunlit Days. An immersive and sensory journey through light and color that takes us back to our roots and transports us to a more natural, more sustainable and more compassionate future.

Presenting the first Silestone® Carbon Neutral collection, a commitment to sustainability where we reduce and offset the emissions from the manufacturing process with reforestation projects. This environmental commitment translates into a collaborative program for the preservation of the seabed and our environment.

Sunlit Days is inspired by evocative Mediterranean tones, and a unique lifestyle.

A new breath. A new spirit. A new Silestone®.



WITH
HYBRIQ+
TECHNOLOGY®





Faro White

White is the color of the Mediterranean. The one that draws the waves on its shore. The one that reflects its light and evokes its warmth. White transmits serenity. It is the color of simplicity, and yet, the most complex and versatile of all colors. It's texture is surprisingly silky to touch, every time.

Faro White is inspired by the lighthouses that draw the way for ships, filling any space with light.

Faro White is the sparkle that brings us closer to what really matters: our people.

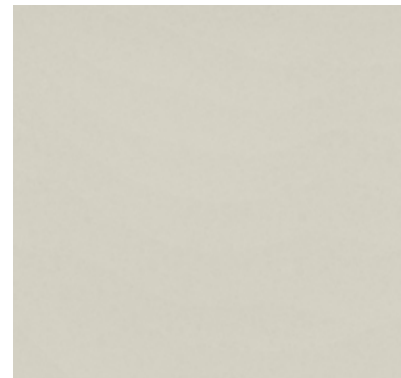

Faro White pairs well with natural fibres and aged woods, raffia and metals with matte finishes.

It is a good match for decorative elements of pure and curved lines, giving rise to spaces stripped of ornamentation which convey calmness.

Cincel Grey

Some people say that gray is just gray. Those people will speak of wood as just that, wood. They will not speak of ebony, almost jet, nor of crimson mahogany. Because wood is not just wood, nor is gray just gray.

Cincel Gray is a fine-grained gray, silky and full of nuances. A gray that when bathed in light unfolds its melody of contrasts between matte, sheen and reminiscent of other colors. It is a gray for those who know how to look and feel.

Its touch, like the rest of the colors in the series, is a sensory experience even for the hands most accustomed to delighting in the textures of each wood.

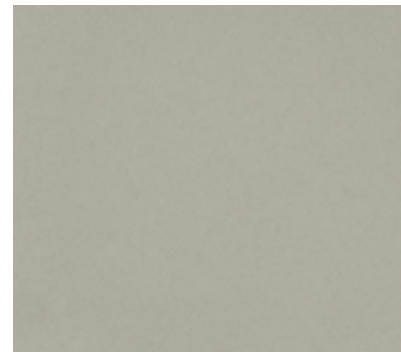

Cincel Grey is a neutral, adaptable gray that balances easily between warm and cool tones. Therefore it complements polished metals and rustic finishes and combines very well with accents of earthy colors, and resistant fibres such as plush velvet, felt and denim.

It is a perfect color for everyday spaces paired with textiles and elements that pay tribute to minimalism.



Cala Blue

The first time you see the sea and its breeze embraces you. The feeling of floating in the immensity. Away from worries, letting the sun and water bathe your skin. Savor the salt that envelops your body, the sound of the waves breaking on the shore, see the infinite horizon. A game for the five senses. A unique touch that caresses the skin just like the sea.

That is Cala Blue. A deep, modern blue that simulates the balance between the depth and the surface of the sea when interacting with light. A mature color that vibrates with the rest of the elements which complement the space it inhabits. Let yourself be rocked by the Mediterranean.

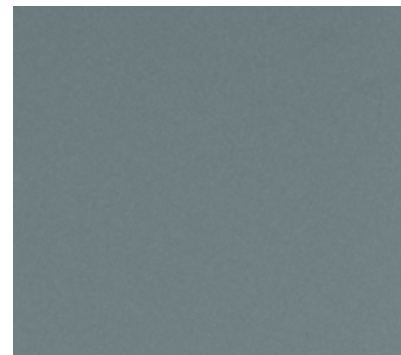

The versatility of Cala Blue allows combinations with dark woods such as walnut and ash, as well as with dark metals to give a more classic look. Paired with nude colors and woods, it is perfect for rustic spaces.



Posidonia Green

Under the Mediterranean, time stands still. Everything is slowness and harmony. The posidonia meadows sway, dancing a hypnotizing dance of incredible greens. Greens that captivate the eye and that both literally and metaphorically, fill the seabed with life.

This is Posidonia Green. A green that asks for colors around it and that transports this beauty so far inaccessible to our spaces. A green that infuses vitality, joy and nature on all four sides. A green that at every moment breathes a different melody of brightness and tones, just like the marine treasure that gives it its name.



Posidonia Green is the perfect match for woods such as bamboo, soft textures, fibres such as cotton or Lyocell, and twill-like structures which help to create these spaces.

Marbling, rustic, natural elements and monochromatic geometries are perfect options to complement this luminous green.



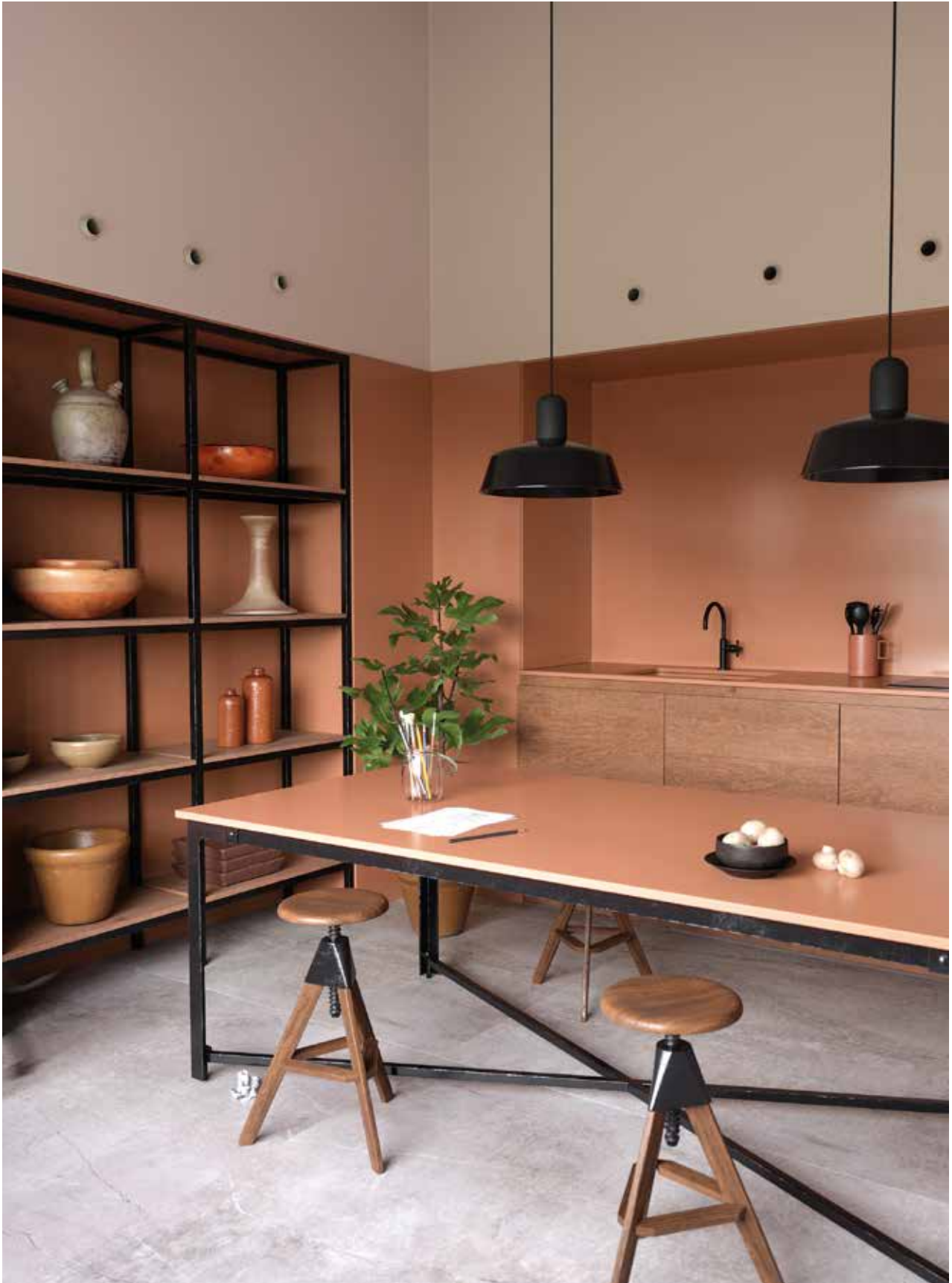



Arcilla Red

There is a land that breathes fire, that seems to flow blood, a land that is pure life. A land of clay, of an infinite red that displays intoxicating tones and fills you with warmth, life and joy.

This is Arcilla Red. A red that makes you fall in love. An earthy red that tastes like wine and smells like petrichor. A red that brings the purest essence of our origins to our home. A burst of color, an accent, a beating heart. A red that turns the kitchen into a living space that longs to be lived in. A color that can be tasted with all five senses. A unique texture that can be enjoyed with both touch and sight. Arcilla Red comes to endow any space with this passion, this closeness to the earth, with pure life.

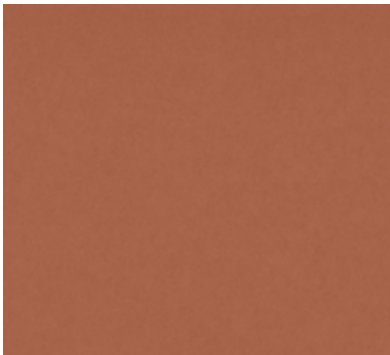

Arcilla Red pairs nicely with reddish woods such as oak or cedar as well as grayer woods like anthracite. Gun metal metals and handmade fabrics are perfect companions to create rustic and bohemian spaces.



Beauty Beyond Natural





New Ethereal Collection

Introducing the Ethereal collection. An unparalleled leap in design, sustainability and innovation developed with HybriQ+® technology, which takes the concept of marble inspired colors to a new dimension.

Ethereal, an evolution of our popular Eternal Collection, interprets the dreamlike beauty of the sky by drawing fine veins of deep hues on white canvases. The result: the most cutting-edge and avant-garde Silestone® series, a redefinition of veining that creates a new category in terms of performance and design.

Ethereal Dusk

Ethereal Dusk is that unique sunrise, that unparalleled feeling of being the first person to see the light of day, where peace is seen on the horizon in the last moments of darkness. The subtle bluish tone of its veining gives it a modern touch that, together with its avant-garde linear pattern, makes Ethereal Dusk one of the most urban and contemporary designs in the collection.



Reddish wood and metals reminiscent of rust, such as gunmetal, or old-cut metals, such as bronze and copper, also go well with this color.





Ethereal Haze

Ethereal Haze is a soft color with a strong character, in which the interplay of patterns merges with the deep, neutral background color. Ethereal Haze is a sea of clouds that offers the sensation of being on the edge of immensity. A veil that separates us from the moment in which we live to transport us to imaginary worlds through the wind that moves the clouds over the mountains, creating the illusion of a calm and fluffy sea.



Its combination of cool and warm makes it perfect for spaces with a total wood or cement look. It also works well with coppery metals, gold colors, limestone and more rustic fabrics.





Ethereal Noctis

Ethereal Noctis draws on the designs of the Eternal collection with a new, renewed and conservative approach. Black features add contrast and elegance to the color range. The gray details and the short-veined background provide depth. Inspired by the darkness after sunset, Ethereal Noctis hides and shelters us in the depths of the night, making us feel life with a strange halo of unreality.



This color elevates the sophistication of the interior design, in combination with brass lamps, stained wood flooring and white and gray furniture for a more industrial look. A versatile color suitable for residential use or for large projects.





Ethereal Glow

Our renewed version of a golden classic like Calacatta Gold, but with a bolder, more modern structure. The elegant gold and gray veining of Ethereal Glow blends into a tinged white foundation to add depth to the design. Inspired by the sky, which gives a spectacular display of yellow, red, orange, gray... while the clouds lose their shyness and appear blazing and confident.



Ethereal Glow is inspired by the sunset. A rhapsody of colors in the sky with an igneous glow from which you cannot look away.







Iconic White

Blanco Zeus

Miami Vena

Miami White 17



Bianco Calacatta

Et. Calacatta Gold

Classic Calacatta

Et. Statuario



Ariel

Pearl Jasmine

Desert Silver

White Storm 14



Yukon

White Arabesque

Snowy Ibiza

Blanco Maple 14



Blanco Norte 14



Blanco Stellar 13



Blanco River



Lagoon



Lusso



Lyra



Poblenou



Blanco Orion

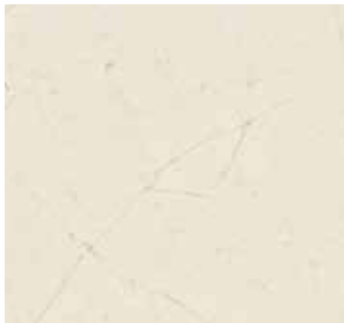

Et. Marfil



Blanco City



Coral Clay Colour



Rougui

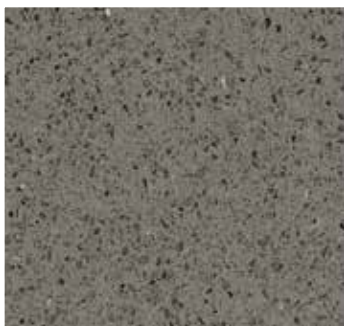

Stellar Grey

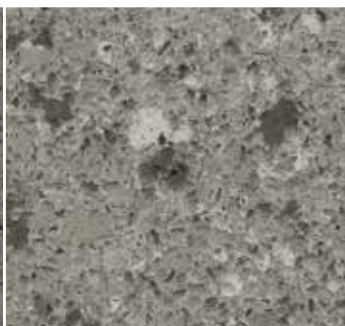

Alpina White 08



Camden



Et. Serena



Aluminio Nube

Kensho

Seaport

Gris Expo

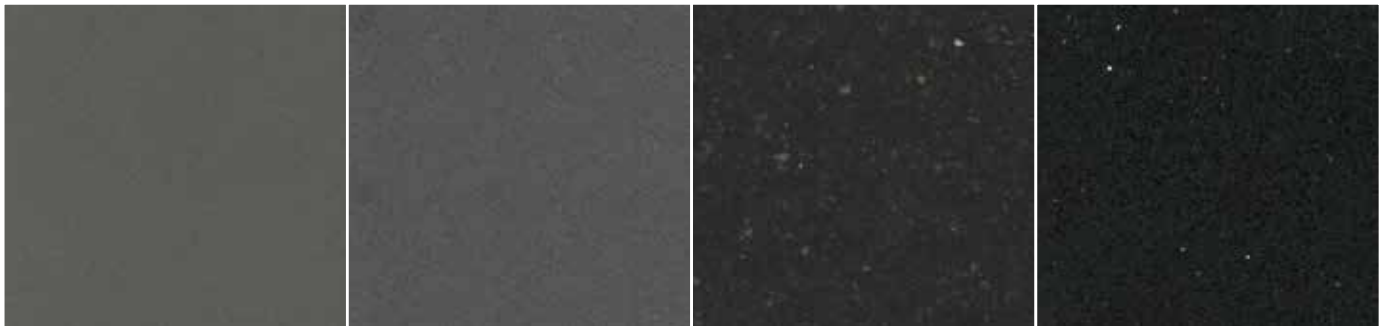

Cemento Spa

Marengo

Arden Blue

Stellar Night

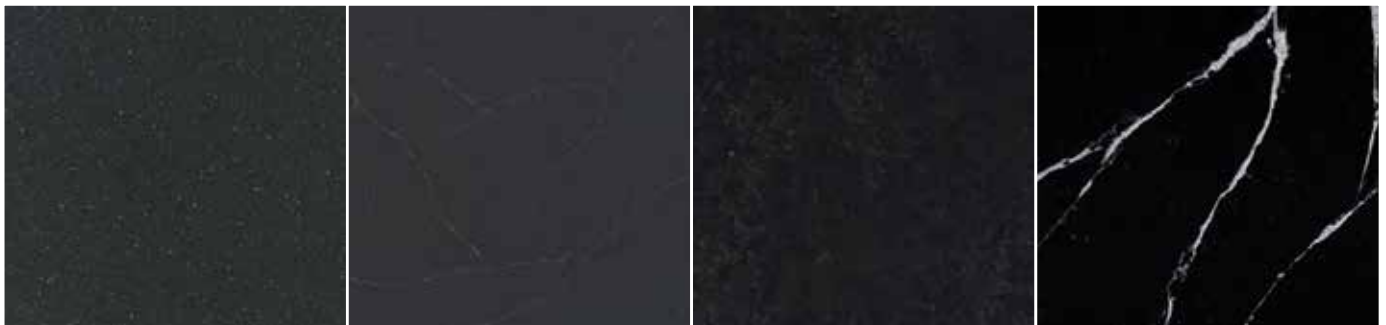

Tebas Black

Charcoal Soapstone

Corktown

Et. Marquina

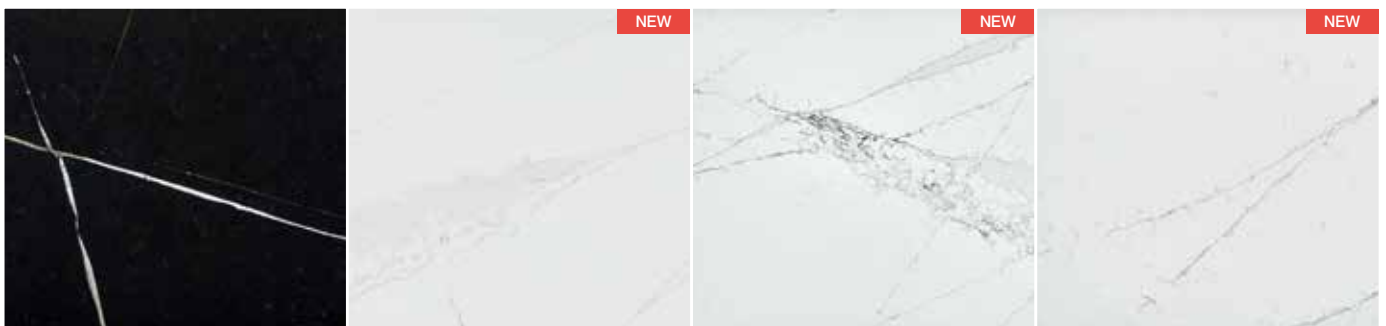

Et. Noir

Ethereal Glow

Ethereal Haze

Ethereal Noctis

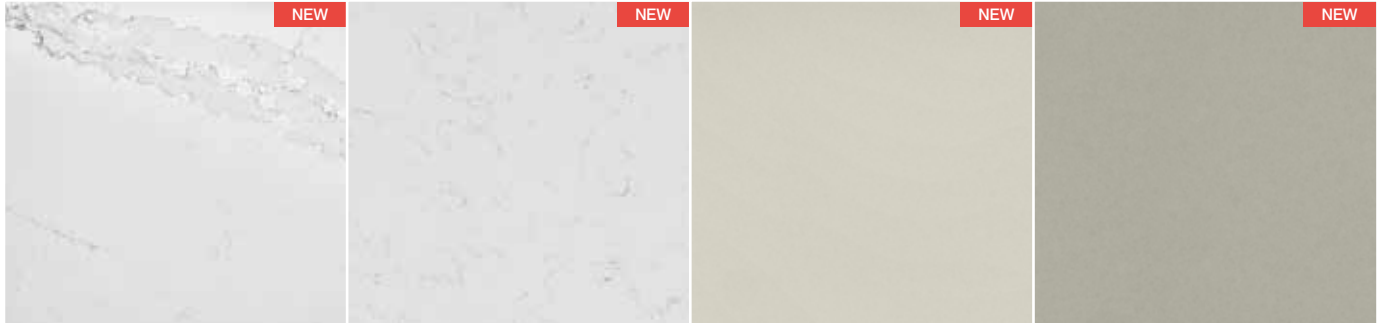

Ethereal Dusk

Halcyon

Faro White

Cincel Grey

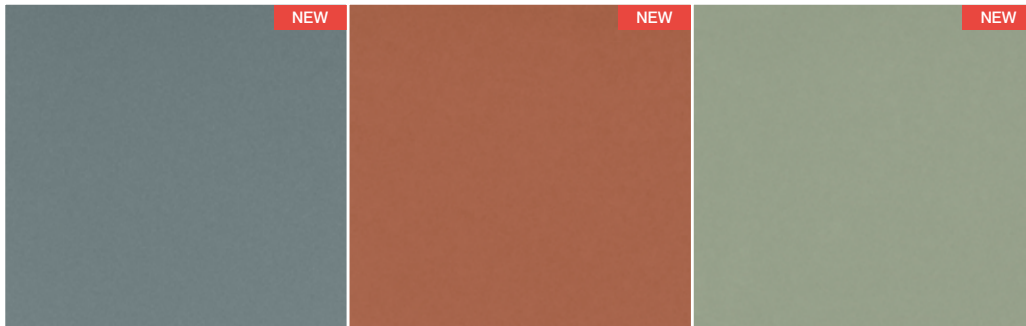

Cala Blue

Arcilla Red

Posidonia Green

GROUP I

BLANCO CITY	Q * ● N ⊖
GRIS EXPO	Q * ● ✨ ⊖ N
MARENGO	Q ⊕ * ● N
ROUGUI*	Q * ● ⊖ N

GROUP II

ARDEN BLUE	Q * ● ✨ ⊖
BLANCO MAPLE 14	Q * ● ⊖ N
BLANCO NORTE 14	Q * ● ⊖ N
CAMDEN	Q ● ⊖
CEMENTO SPA	Q * ● ✨ N
CORAL CLAY COLOUR	Q * ● ⊖
MIAMI WHITE 17	Q * ⊖
TEBAS BLACK	Q ⊕ * ● ⊖ N
WHITE STORM 14	Q * ● ⊖ N

GROUP III

ALPINA WHITE 08	* ● ⊖
ALUMINIO NUBE*	Q * ● N
ARIEL	Q * ● ⊖
BIANCO RIVER	Q * ● ✨ N
BLANCO STELLAR 13	Q * ● N ⊖
DESERT SILVER	Q * ● ⊖
HALCYON	Q * ⊖
LUSSO	Q * N
MIAMI VENA	Q * ● ⊖
SNOWY IBIZA	Q * ● ⊖
STELLAR GREY	Q ⊕ * N
STELLAR NIGHT	Q ⊕ * N ⊖
YUKON	Q * ● N

GROUP IV

ARCILLA RED NEW	Q+ ● ⊖
BLANCO ORION*	Q * ● N
BLANCO ZEUS	Q * ● ✨ N ⊖
CALA BLUE NEW	Q+ ● ⊖
CORKTOWN	Q+ ● ⊖
CINCEL GREY NEW	Q+ ● ⊖
ET. SERENA	Q * ● ⊖
FARO WHITE NEW	Q+ ● ⊖
KENSHO	Q * ● N ⊖
LAGOON*	Q * ● N ⊖
LYRA*	Q * ● N
NOLITA	Q+ * ● ⊖
POBLENOU	Q+ ● ⊖
POSIDONIA GREEN NEW	Q+ ● ⊖
SEAPORT	Q+ ● ⊖
WHITE ARABESQUE	Q * ● N

GROUP V

CHARC. SOAPSTONE	Q ⊕ * ● ⊖
CLASSIC CALACATTA	Q * ● ⊖
ET. MARFIL	Q * ● ⊖
ET. MARQUINA	Q ⊕ * ● ⊖
ET. STATUARIO	Q * ● ⊖
ICONIC WHITE	Q ⊕ * ● ⊖
PEARL JASMINE	Q * ● ⊖

GROUP VI

BIANCO CALACATTA	Q * ● ⊖
ET. CALACATTA GOLD	Q * ● ⊖
ET. NOIR	Q ⊕ * ● ⊖
ETHEREAL DUSK NEW	Q+ * ● ⊖
ETHEREAL GLOW NEW	Q+ * ● ⊖
ETHEREAL HAZE NEW	Q+ * ● ⊖
ETHEREAL NOCTIS NEW	Q+ * ● ⊖

- * POLISHED
- SUEDE
- ✨ VOLCANO
- ⊕ INTEGRITY
- ⊕ N-BOOST TECHNOLOGY®
- ⊖ STANDARD SLAB
- ⊖ JUMBO SLAB
- Q HYBRIQ TECHNOLOGY®
- Q+ HYBRIQ+® TECHNOLOGY

For ● Suede and ✨ Volcano finishes please ask for availability.

The provided samples don't guarantee that the supply will be absolutely identical in tone and veins.

See General Conditions of Sale.



Sensa

by Cosentino®

Protected Natural Stone

Sensa by Cosentino® is premium maintenance-free natural stone brought to you by Cosentino, a world leader in the natural stone industry.

Sensa by Cosentino® is treated with a revolutionary stain protection treatment called SenGuard, and comes with a 15-year warranty.

SENSA
15
YEARS
WARRANTY

SENSA
by COSENTINO®



Applications

Sensa kitchen countertops.
Natural, stain-resistant beauty.

Enjoy the design, hardness and resistance of natural stone without fear of stains. Sensa by Cosentino® quartzites and granites feature a revolutionary stain-resistant treatment that protects them for the life cycle of your countertops.



Sensa by Cosentino® Treatment

The long-lasting, chemically-integrating technology allows the material to breathe. This technology enhances its powerful properties.

The process alters the surface tension of the stone causing the material itself to prevent liquids such as water, coffee or oil from penetrating.



SENSA
by COSENTINO®

TRADITIONAL

Textures

Unique patterns for
irrepliable surfaces.

The colors and textures of Sensa by Cosentino® have the patient and whimsical design of nature. Each of the seven available shades has a texture that produces different effects and sensations: suede, polished or caresse.





Siberia *



Taj Mahal *



White Macaubas *



Colonial White *



Vancouver ●●



San Angelo ●●



Ice Blue *



Indian Black *



Black Beauty ●●●



Platino ●●



Silver Grey *



Graphite Grey *●●



Nilo *

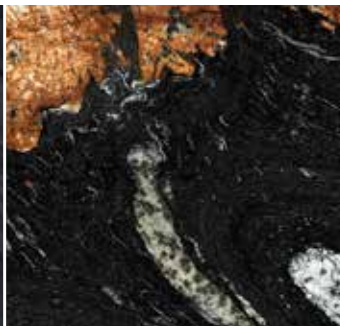

Orinoco *

* POLISHED

●● SUEDE

●●● CARESSE



COLOR	FINISH 2 & 3 CM	COLOR	FINISH 2 & 3 CM
BLACK BEAUTY	CAS	ORINOCO	MIR
COLONIAL WHITE	MIR	PLATINO	LEA
GLACIAL GREY	MIR	SANT ANGELO	SUE
GRAPHITE GREY	CAS	SIBERIA	MIR
ICE BLUE	MIR	SILVER GREY	MIR
INDIAN BLACK	MIR	TAJ MAHAL	MIR
MOACK BLACK	SUE	VANCOUVER	LEA
NILO	MIR	WHITE MACAUBAS	MIR

The samples provided do not guarantee that the supply will be absolutely identical in tone and grain. Consult the general conditions of sale

- CAS CARESSE BRUSHED AND POLISHED
- MIR MIRAGE POLISHED
- SUE SUEDE
- LEA LEATHER

Natural Stone

by Cosentino®

From the Earth

We have selected the most premium natural stones from the best producer of all time: Earth.



Advantages Natural Stone®

Natural Stone is Cosentino's collection made up of natural stones, chosen through an exhaustive selection process. This collection of natural stones is inspired by the origins of the Cosentino Group, as a brand that has worked with noble materials such as marble, granite, limestones and travertines. Its extraordinary resistance and durability, together with whimsical and unrepeatable designs, make Natural Stone a safe bet for the professional.

- More than 100 materials in the portfolio.
- Technical sheets and Declaration of Performance upon request.
- Stocks locally in our own Centers.



→ Natural Stone Blanco Macael. "Patio de Los Leones". Alhambra of Granada.



→ 72

5.1 LIVINGS

Redesign the living room and turn it into an open, functional, comfortable space integrated with the rest of the house.



→ 78

5.2 BATHROOMS

Reinvent the bathroom space to create a world of sensations through a unique and integrated design concept.

Spaces

→ 95

5.3 OUTDOOR

Revolutionize the outdoor space so that the porch, terrace or garden become a continuation of the house.

Innovative surfaces that bring the designer's vision to life throughout the home, in both indoor and outdoor spaces

→ 106

5.5 FURNITURE

Rediscover the exclusivity of custom-designed furniture for every space.

→ 98

5.4 KITCHENS

Redefine the function of the kitchen in the home and transform it into the heart of the house.



Living rooms

The living room is transformed into a personal and timeless space with Cosentino surfaces; an expression of sophistication and functionality.





Live your space

Rediscover your home's living space

An integrated solution with maximum versatility and functionality.

Endless personalization possibilities.

Limitless customization

Designing a living room with high aesthetic value requires versatile surfaces in a variety of colors, textures, and unique chromatic pantones, such as Dekton and Silestone, which will cover floors, furnitures, cladding, and more, to create an integrated and differential interior design experience.

Perfect for high-traffic areas

Dekton® is an innovative surface with a high level of resistance, capable of withstanding high temperatures, ultraviolet rays and any scratches. It remains unalterable to wear and abrasion, as a result of the high daily traffic in spaces such as living rooms.

Easy installation

Dekton® is offered in a Slim format which is light, easy to cut, and adaptable to every space. Its thin thickness of 4mm allows adjustments to be made during installation, using tools for ceramic tiles.

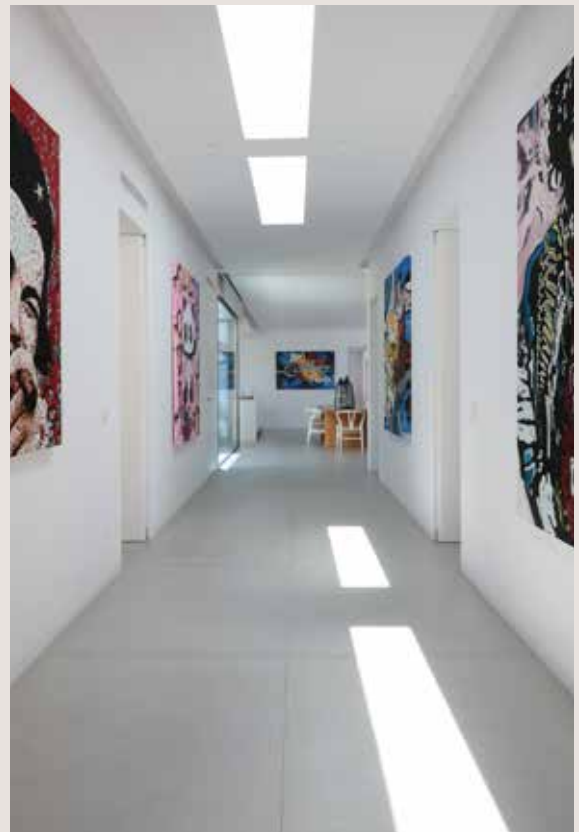



Comprehensive solutions

The same material for flooring, cladding and furniture creates visual continuity and high aesthetic impact, unifying spaces and increasing their functionality.

New Dekton® Optimma Format

Dekton® has been optimized for interior cladding. The Optimma format (2600x1000x4 mm) allows for cost efficiencies, more design possibilities and easy installation and manipulation. The results: impactful cladding and integrated spaces.

Large format, minimal joints

Dekton® Slim's large format up to 3200 x 1440 mm and thickness of 4 mm allows you to cover large surfaces creating a continuous and homogeneous aesthetic for cladding and furniture. This size reduces the number of joints, easing cleaning and maintenance.





Cosentino Bathrooms

Cosentino® helps you
to rediscover your
bathroom space through a
unique and integrated
design concept.





Bathroom Spaces

Reimagine the most personal space in the home. Create a unique experience in which the most beautiful and functional Cosentino® surfaces create unique, warm, and exclusive spaces.

From wall and floor claddings in different yet perfectly balanced formats, colors and textures, to attractive vanities and shower trays, carefully designed with great attention to detail and simplicity.

Solutions of great aesthetic and functional value to suit every requirement and style of bathroom, which redefine the way in which we experience such a personal space and feeling of well-being.

Large format

Large format, minimal joints. Tailor-made floors and wall cladding.

Bathrooms are exposed to constant activity. Using a high-quality surface for floors and cladding reduces joints and guarantees hygiene and cleanliness. The strategically placed slabs in XXL make the room look bigger, creating the sensation of a larger bathroom.

Shower Trays

Shower trays with Dekton® Grip+ and Silestone®: exclusive and integrated designs in the bathroom with limitless customization possibilities.

Cosentino® offers an extensive collection of shower trays in the material the architect or designer chooses and adaptable to any space. It is an interesting alternative to the traditional shower that simplifies installation and assembly.

Optimma Format

Dekton® Optimma Format. Optimized for interior bathroom cladding: taking full advantage of the space, easy installation, and design continuity in a vertical format.

The Optimma slab format is available in 260 x 100 cm and 0.4 cm thicknesses, and is able to meet any vertical cladding need to create a continuous design, taking advantage of the full height with easy installation and minimum waste.

Sinks

Sinks and vanity tops with great versatility that adapt to any space. Sophisticated designs with maximum beauty and durability.

Silestone® sinks are built with a unique and innovative design able to live up to the most demanding creative proposals. From sinks that integrate into the vanity top, to overmount options, double bowls...everything is possible with tailor-made fabrication.

Optimma Format

Dekton® Optimma Format. Optimized for interior bathroom cladding: taking full advantage of the space, easy installation, and design continuity in a vertical format.

The Optimma slab format is available in 102" x 39" and 0.4 cm thicknesses, able to meet any vertical cladding need creating a continuous design, taking advantage of the full height with easy installation and minimum waste.



Total Integration

Total aesthetic integration and visual continuity. The same material for your entire bathroom: floor, cladding, shower tray, and sink.

A single surface applied to every component of the bathroom allows for complete esthetic homogeneity, creating harmony, balance, and amplitude.



Colors and textures

New collections of innovative, on-trend colors and textures, to create bathroom spaces full of originality and impact.

Innovative Silestone® and Dekton® surfaces possess a wide variety of solid and veined colors, unique chromatic pantones, and sensory textures to rediscover bathroom spaces.









Sinks

Full array of products.

Sinks and worktops designed to adapt to any space.



Armony

The evolution of tradition makes this sink a key piece, bringing harmony and definition.



Available in a wide variety of colors.

Check available colors at [cosentino.com](https://www.cosentino.com)

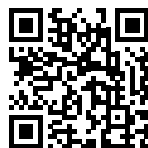



Elegance

Silestone®

Basin 49 x 30 x 10 cm
 Length from 59 to 320* cm
 Width from 40 to 60 cm
 Straight edge of 2 cm or Skirt 12,5 cm



Reflection

Silestone® / Dekton®

Basin S 49 x 30 x 8 cm
 Basin M 90 x 30 x 8 cm
 Basin L 120 x 30 x 8 cm
 Length from 59 to 320* cm
 Width from 40 to 60 cm
 Straight edge of SI 2 or DK 1,2 cm or Skirt 12,5 and 16 cm



Armony

Silestone®

Basin 49 x 30 x 10 cm
 Length from 59 to 320* cm
 Width from 40 to 60 cm
 Straight edge of 2 cm or Skirt 16 cm



Silence

Silestone® / Dekton®

Basin S 49 x 30 x 8 cm
 Basin M 90 x 30 x 8 cm
 Basin L 120 x 30 x 8 cm
 Length from 59 to 320* cm
 Width from 40 to 60 cm
 Straight edge of SI 2 or DK 1,2 cm or Skirt 12,5 and 16 cm



Symmetry

Silestone®

Basin S 33 x 23 x 7 cm
 Basin M 38 x 25 x 7 cm
 Basin L 58 x 30 x 7 cm
 Length from 55 to 320* cm
 Width from 43 to 60 cm
 Straight edge of 2 cm or Skirt 10 cm



Simplicity

Silestone® / Dekton®

Basin 49 x 30 x 10 cm
 Length from 59 to 320* cm
 Width from 40 to 60 cm
 Straight edge of SI 2 or DK 1,2 cm or Skirt 12,5 and 16 cm

Integrity Sinks

Full array
of products

Sinuous, organic and linear shapes, made
on hygienic easy-to-clean surfaces.



Marie

Three sizes in a design
of round and functional
encounters that combines
technology, integration,
and practicality.



Available in a wide
variety of colors.

Check available colors
at [cosentino.com](https://www.cosentino.com)





Marie
Silestone®

Basin Marie Top: 51 x 37 x 10 cm
Basin Marie S: 34 x 37 x 7 cm
Basin Marie L: 51 x 37 x 7 cm

Length from 47 to 320* cm
Width from 44 to 60 cm
Straight edge of 2 cm or Skirt 10 cm
(Marie Top) or 12,5 cm (Marie S and L)



Evita
Silestone®

Basin Evita S: 50 x 30 x 10 cm
Basin Evita L: 65 x 30 x 10 cm
Basin Evita Q: 51 x 41 x 10 cm

Length from 60 to 320* cm
Width from 40 to 60 cm
Straight edge of 1,2 cm or Skirt 12,5 cm

H-Line Sinks

Different worktop and bathroom shelf solutions, with a modern and design adaptable to any need, adding sophistication to the bathroom space.



Urban porcelain overmount

Silestone®
Dekton®

Length from 45 to 320* cm
Width from 46 to 60 cm
Straight edge of 1,2 cm or Skirt 10 cm



Flex porcelain undermount

Silestone®
Dekton®

Length from 60 to 320* cm
Width from 46 to 60 cm
Straight edge of 1,2 cm or Skirt 10 cm

Shower Trays

Full array of products

Five adaptable shower tray models in a variety of materials and finishes of Dekton® and Silestone®, suitable for any space in the home and technical requirements, no matter how complex.



Gocce

Our new simpler and more functional design that adapts to all spaces.



Available in a wide
variety of colors.

Check available colors
at [cosentino.com](https://www.cosentino.com)





Wakka

Silestone®

Length from 70 to 250 cm
Width from 70 to 150* cm



Wakka Brim

Silestone®

Length from 70 to 250 cm
Width from 70 to 150* cm



Kador Suite

Silestone®

Length from 70 to 200 cm
Width from 70 to 150* cm



Gocce

Dekton® Grip+

Length from 70 to 190 cm
Width from 70 to 96 cm



Exilis

Silestone®

Length from 70 to 320* cm
Width from 70 to 150* cm

* Only in Jumbo format

Flooring

Tailor-Made and standard formats

Achieve aesthetic continuity in the bathroom floor with standard format solutions or personalized ones of great resistance when faced with fluctuations in humidity and temperatures. Minimal jointing and maintenance-free.



Available in a wide variety of colors.

Check available colors at [cosentino.com](https://www.cosentino.com)

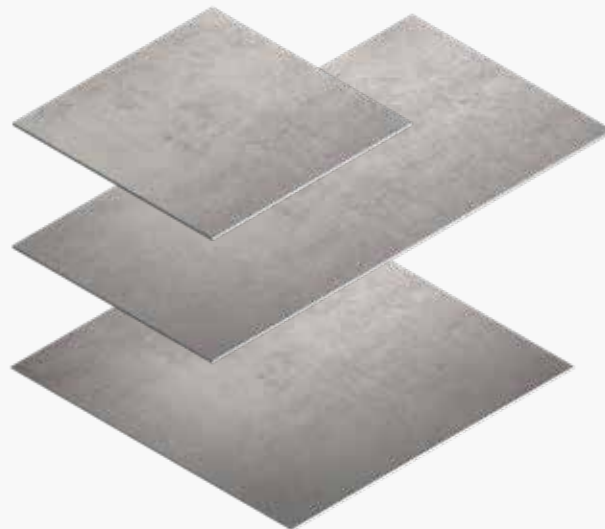
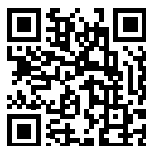

HLine Bath tops

Horizontal and functional planes with straight lines created by Silestone® and Dekton® to create a variety of sophisticated sinks in the same material.



Available in a wide variety of colors.

Check available colors at [cosentino.com](https://www.cosentino.com)

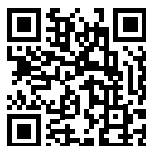



S Format

Dekton®
71 x 71 cm

M Format

Dekton®
142 x 71 cm

L Format

Dekton®
142 x 142 cm

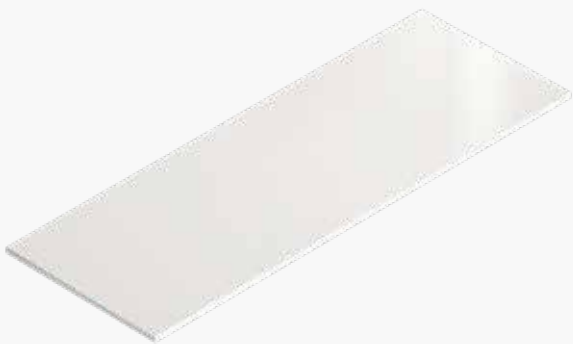

**Straight edge
worktop**

Silestone® / Dekton®

Length from 60 to 320 cm
Width from 30 to 60 cm
Straight edge of 1,2 cm

**Worktop
with skirt**

Silestone® / Dekton®

Length from 60 to 320 cm
Width from 30 to 60 cm
Skirt 6, 10 or 21 cm

Cosentino Exterior Spaces

Beautifully continuous
and durable
outdoor spaces.

Redesign your
outdoor spaces to
include porches and
terraces that blend
in with your home.



Exterior Spaces





Customization without limits

Open spaces with freedom for inspiring, designing with a unique purpose: personalizing your outdoor spaces.



Easy installation

Dekton® is very lightweight, easy-to-cut and adaptable format.



High transit resistance

It remains unalterable faced with daily erosion and abrasion in outdoors spaces, used in terraces, stairs and pool surroundings.



Dekton® Outdoor Countertops

Dekton® outdoor countertops are resistant and durable. Innovative surfaces turn into functional and beautiful countertops.

Cosentino Kitchens

Reinventing the
kitchen to make it
the heart of the home.





Kitchen Spaces

It's been a long time since the kitchen was a forgotten room in the darkest part of the house. The kitchen is now a key space that can integrate with the living-dining room and share the same design.



Integration within the space

The kitchen as a living space which connects to the rest of the house. Total integration of the worktop with the living room cladding or floor.



Kitchen Countertop and Island

Thousands of households all over the world have trusted Cosentino to provide them with a kitchen that is not only functional and beautiful, but also plays a key role in the daily lives of their families. We offer a wide range of colors and textures, so you're sure to find your perfect countertop.



Kitchen Flooring and Cladding

In this so-called “reconversion” process, the island plays a major role, as it serves as a connecting element between the two environments as well as a meeting place in the home. In this project, the interior designer built the entire design around the island.



Island in a classic material.

Although this kitchen has a distinctly modern look, the designer has opted for a classic material for the countertop: **Silestone® Calacatta Gold** in a polished finish. The use of a 5 cm strip and the diagonal cut on the front side bring modernity and style to a material reminiscent of ancient marble.

- Kitchen countertop
Silestone® Calacatta Gold, Polished finish





Silestone® Integrity Sinks

Full range
of products.

Without joints, cracks, or limits. Integrity wants to unite your kitchen with surfaces without an ending or beginning. Integrity brings a sense of unity and perfect integration with the rest of the elements on your countertop. A single piece available in a range of Silestone® colors, so your kitchen is endless.



Available in
a wide variety
of colors.

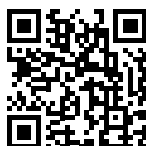

Check available colors
at [cosentino.com](https://www.cosentino.com)

Silestone® Integrity offers all the
features that that have made
Silestone a market leader: high
scratch resistance, durability
and of course the highest
performance in terms of design.



**Integrity
Due S**

Silestone®

Outer measure 40 x 37 x 17.5 cm
 Inner measure 37 x 34 x 15.5 cm
 Radius between walls 6.5 cm
 Radius between bottom and sides 0.3 cm



**Integrity
One**

Silestone®

Outer measure 54 x 44 x 17.5 cm
 Inner measure 51 x 41 x 15.5 cm
 Radius between walls 13 cm
 Radius between bottom and sides 0.3 cm



**Integrity
Due L**

Silestone®

Outer measure 54 x 40 x 17.5 cm
 Inner measure 51 x 37 x 15.5 cm
 Radius between walls 6.5 cm
 Radius between bottom and sides 0.3 cm



Integrity Q

Silestone®

Outer measure 55 x 44 x 17.5 cm
 Inner measure 51 x 41 x 15.5 cm
 Radius between walls 3 cm
 Radius between bottom and sides 3 cm



**Integrity
Due XL**

Silestone®

Outer measure 70 x 46.5 x 23.5 cm
 Inner measure 67 x 43.5 x 21 cm
 Radius between walls 6.5 cm
 Radius between bottom and sides 0.3 cm



**Integrity
Top**

Silestone®

Outer measure 54 x 40 x 17.5 cm
 Inner measure 51 x 37 x 15.5 cm
 Radius between walls 6.5 cm
 Radius between bottom and sides 0.3 cm



Furniture

Surfaces integrated with unique and timeless furniture design.

Dekton®, The skin of the furniture

It's on-trend to use the same cladding on the kitchen or bathroom countertop to clad drawers and wardrobes. This allows you to achieve continuous and clean surfaces where joints disappear, creating a monolithic effect.

This decor trend is only possible with the technological evolution of materials. 8 mm and 12 mm thicknesses are ideal for tables and coffee tables. Dekton Slim 4mm thickness allows kitchen and bathroom furniture cladding, and also answers the creative restlessness of the designer: table tops for the interior and exterior completely personalized and exclusive.

Furniture

Unprecedented
durability and design.

Cosentino® surfaces
redefine furniture thanks
to their versatility,
durability, and beauty.





→ Kitchen furniture cladding, Dekton® Slim Opera



Dekton® Slim, 4 mm thickness makes it an incredibly easy material to work with. Its light weight and properties make it the ideal solution to clad all types of furniture and adapt to any aesthetic proposal: in white and gold, in black and chrome...

Dekton® Slim has all the advantages and properties of Dekton, including high resistance to scratches and stains.

Ideal for cladding closet doors and kitchens

Dekton® Slim Zenith and Dekton® Slim Opera were the two tones chosen to hide these drawers under the stairs and on kitchen cabinetry. The result is a camouflaged surface of this practical storage solution, without compromising the aesthetic of the space.

→ Kitchen furniture cladding, Dekton® Slim Kreta



Cabinets integrated into the island

Dekton® Slim is the perfect solution to clad drawers in the kitchen island, achieving a monolithic effect.

For this industrial project, the designer chose Dekton Trilium: a finish inspired by volcanic rock with a touch of oxidation, which adds great character to the space.

Once again, Slim's 4 mm thickness allows the creation of an island totally integrated with drawers.



→ Kitchen furniture cladding, Dekton® Slim Trilium



→ Table top, Dekton® Laos



→ Table top, Dekton® Laos



→ Table top, Dekton® Trilium



→ Table top, Silestone® Eternal Statuario



Ideal for work spaces

The properties of Dekton® and Silestone® make these materials the perfect choice for work spaces. With their endless possibilities in terms of finishes and designs, they add a deco touch to these spaces and create attractive and functional tables suitable to work from home.

COSENTINO®

COSENTINO UK

10, Bartley Point, Osborn Way
Hook RG27 9GX
United Kingdom

info.uk@cosentino.com

   @Cosentino UK
www.cosentino.com/en-gb



* To obtain more information about hues with NSF certification please visit www.nsf.org

** The Carbon Neutral certification only applies to the Sunlit Days series.