

# UKIYO

## Design, installation, use & care

COSENTINO® SPACES  
UKIYO. DESIGN, INSTALLATION, USE & CARE

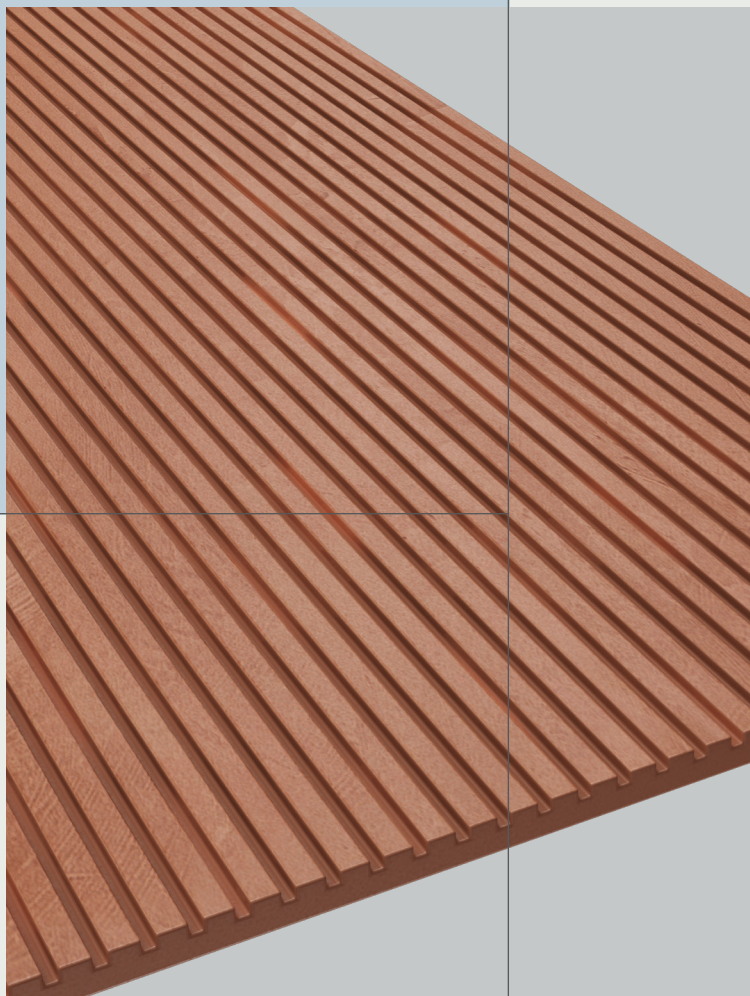

# Index

Description & product features	4
Introduction	4
Typologies	5
Recommended use & applications	6
Installation on site	7
Palletizing and transport of the material	7
On-site handling and support equipment	7
Recommendations for tile adjustments	8
Tools for elaboration and installation	9
Installation process and recommendations	10
Health & safety	14
Use & maintenance	16
Final cleaning of the job	16
Maintenance cleaning	16
Daily cleaning	16

## Description & product features

### Introduction

→ What is Dekton®?

Dekton®, the most technological ultra-compact stone.

Dekton® is our innovative ultra-compact surface.

Its exclusive production process and the sophisticated blend of more than 20 minerals extracted from nature give the surface unique aesthetic and functional characteristics.

→ What is UKIYO?

It is the **development of textures in Dekton®**, specially designed for application in **interior vertical cladding**.

**Two types of surface grooving**, in collaboration with designer **Claudia Afshar**, that help to create beautiful and unique spaces.

→ What colors are available for UKIYO?

UKIYO is available in **5 colors**: Bromo, Kreta, Nacre, Rem kC and Umber. In addition, for projects, it will be available in those colors with **Matte or Velvet** finish from the Dekton® portfolio.



→ ( \* ) For other colors, check availability under minimum order of units with Cosentino® Product Department.

### Typologies

Which of these two texture patterns best suits your design?

→ Ukiyo GV2

#### Dimensions

Tile width: 450 mm [17 2/3"].  
Tile length: 3,000 mm [118"].

#### Thicknesses

8 mm | 12 mm.

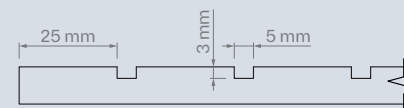
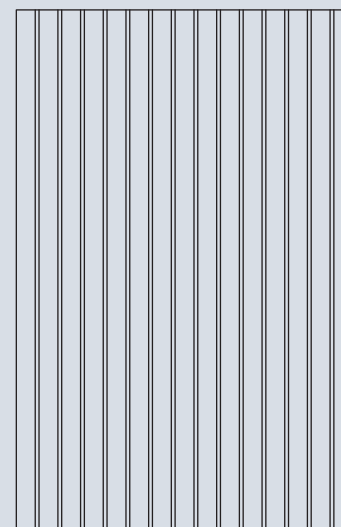

25 mm [1"] | Fluting: 5 mm [3/16"].  
Fluting depth: 3 mm [1/8"].  
Number of surface grooves: 15.

The tile starts with a smooth finish surface and ends in a surface groove, facilitating the placement of one tile after another.

→ Ukiyo GV3

#### Dimensions

Tile width: 450 mm [17 2/3"].  
Tile length: 3,000 mm [118"].

#### Thickness

12 mm.

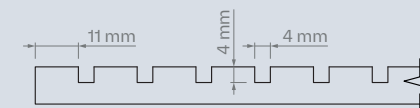
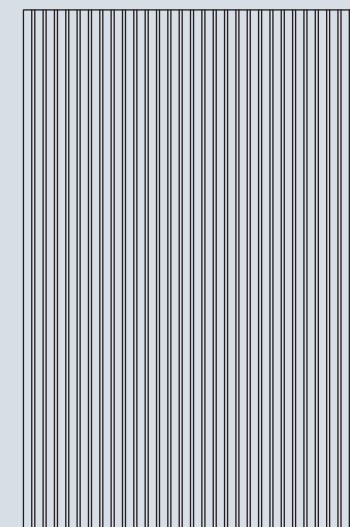

11 mm [1"] | Fluting: 4 mm [1/8"].  
Fluting depth: 4 mm [1/8"].  
Number of surface grooves: 30.

The tile starts with a smooth finish surface and ends in a surface groove, facilitating the placement of one tile after another.

## Recommended use & applications

→ This product is specially designed for vertical cladding application glued on continuous support for interior use.

→ Do NOT use as a horizontal surface or on a ventilated facade.

→ It is not recommended for use in applications where the product is subjected to weathering or extreme environmental conditions.

→ Similarly, do not use in applications where the surface is constantly damp or wet, or in places where it may come into frequent contact with pigmented and/or oily products. Deterioration of the appearance of the product could occur, particularly, by the appearance of stains in the grooved area.

→ Once Dekton® UKIYO has been chosen as the cladding material, there are a number of factors that guarantee success in a vertical cladding intervention:

- Correct choice of supporting, bonding and joint filling materials. Refer to the Dekton® *Interior Wall Cladding Quick Guide*.
- Carrying out a complete project of the cladding, including the layout and sizing of the joints.
- Proper evaluation and preparation of the substrate. Refer to the Dekton® *Interior Wall Cladding Quick Guide*.
- Correct placement, following proper execution techniques and respecting the product manufacturer's application instructions.

→ Regarding the bonding material or adhesive, it is essential, prior to placement, to consult with the selected local supplier and faithfully follow their product recommendations and application indications.

- In general, Cosentino® recommends a C2TE S1 or S2 type adhesive, depending on the type of substrate on which the installation is to be carried out. Refer to the *Product Approval Sheets* for recommended adhesives that Cosentino® has published.

## Installation on site

### Palletizing and transport of the material

To facilitate on-site stockpiling and transport, the Dekton® UKIYO tiles are supplied in a vertical wooden A-Frame type crate, protected from each other using cardboard separators as shown in the images below.



→ Tiles with cardboard separators on an A-Frame.



→ Finished and plasticized crate, ready for shipment.

The handling of the tiles shall be carried out vertically at all times and the 'special porcelain tile clamps', with a minimum length of 400 mm [15 3/4"], shall be used for a maximum of two units at a time.

To avoid load swinging, the clamp shall be positioned in the central axis of the tile.



→ Examples of recommended clamp.

### On-site handling and support equipment

The handling of large format tiles on site should be carried out vertically at all times, using at least two operators.

It is recommended to use stiffeners, clamps and cut-out protectors (if necessary) for those panels that, due to their size or the size of the cut-outs, are more fragile.

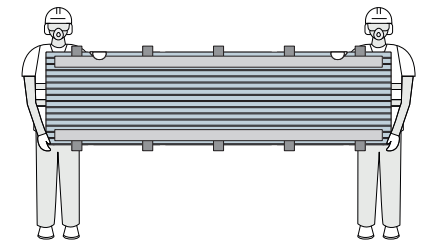

Due to the surface grooving features of the tiles, the use of suction cups is restricted, so it is necessary to pay special attention in their handling, limiting the handling of the tiles manually between at least two people.

## Recommendations for tile adjustments

Cosentino® supplies standard tiles of 3,000 x 450 mm [118" x 17 2/3"]. However, for adjustments, cuts and drill holes can be made with the appropriate tools to deal with design changes, corners, pillars, electrical sockets, etc.

It is recommended to carry out all operations on a continuous support of lower density than Dekton® (e.g. wood) to avoid possible chips, scratches or rubbing.

### → Straight cut with water supply

The product contains crystalline silica. Avoid the formation of airborne dust. Inhalable dust generated during processing can cause serious diseases such as silicosis or lung cancer. Use wet cutting with sufficient water supply. As an additional measure of individual protection, always use high efficiency particulate filtering masks, type FFP3 or the equivalent according to local regulations.

Before starting, check that the following requirements are met:

- The workbench must be continuous, stable and leveled.
- Use cutting tools recommended by Cosentino®.
- Sharpen the tool regularly.

After the cut, we recommend the use of polishing blocks to micro-bevel the tiles.



→ Straight cuts with water supply.

### → Cut-outs

For those tiles with cut-outs or corners, it will be necessary to carry out the according to the following procedure:

1° Pre-drilled holes with a min. radius of 5 mm [3/16"].



2° Continuous straight cutting with water supply.

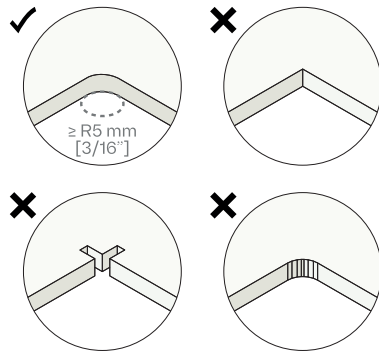

### → Electrical sockets

When drilling holes to make electrical sockets, the use of Ø68 mm [2 3/4"] overlapping drill holes is recommended until the desired size is achieved.

1°

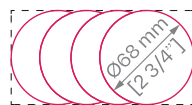

2°

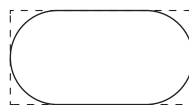

→ Making electrical sockets with overlapping drill holes.

## Tools for elaboration and installation



→ Workbench.



→ Clamps.



→ Tape measure.



→ Spirit level.



→ Approved drill and drill bits<sup>(1)</sup>.



→ Cutting machine<sup>(1)</sup>.

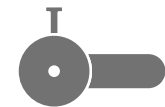

→ Angle grinder<sup>(1)</sup>.



→ Polishing block.



→ Stiffeners and clamps.



→ Recommended adhesive.



→ Plastic trough.

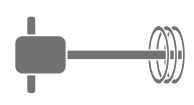

→ Mixer.



→ Mixing trowel.

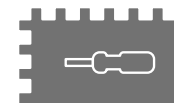

→ Toothed trowel.



→ Leveling kit.



→ Grouting kit.



→ Water supply.



→ Recommended cleaning agent<sup>(2)</sup>.

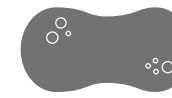

→ Cleaning sponge.

→ (1) Always use with localized suction/water supply.

→ (2) Refer to the section 'Use and maintenance'.

## Installation process and recommendations

### 1. Basic support requirements

Before any work is carried out, it must be checked that:

- The support is dry.
- The support is clean.
- The support is stable.
- The support is leveled.

If this is not the case, take the appropriate measures.

The back of the tile should also be clean.

### 3. Adhesive selection

Take into account the size of the tile and the type of substrate.

Verify and respect all indications from the adhesive manufacturer/supplier.

### 2. Safety fixings

Depending on local regulations and tile height, it may be necessary to install mechanical safety fixings on the back of the tiles.

These fixings may be exposed or concealed.

For further information and recommendations, please consult with Cosentino® Product Department.

### 4. Handling the material on site

Always vertically, resting the tiles on suitable material that does not cause chipping on the edges.

The use of stiffeners and clamps is recommended for those tiles that, due to their size or large cut-outs, are more fragile.

### 5. Double gluing

Installation is carried out according to the technique of 'double gluing' (adhesive on the back of the tile and on the substrate), which ensures perfect adherence and prevents gaps from forming.

Never apply the adhesive by 'sticking' or 'pinching'.

This technique allows for a greater distribution of stress by ensuring the maximum possible contact surface (> 90%) between the substrate and the adhesive and the adhesive and the tile.

The application, both on the substrate and on the tile, would be according to the following diagrams:

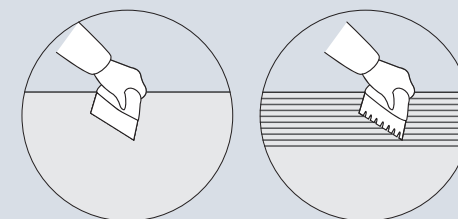

1. Application with the smooth side of the trowel.

2. Combing with the toothed part of the trowel.

### 6. Toothed trowel and direction of the adhesive line

The combing should always be done with a toothed trowel to define its geometry according to the tile format, the substrate and the type of adhesive. This ensures adequate adhesive thickness and good distribution along the surface, including perimeters.

**DIRECTION:** In this case, the adhesive line must be parallel to the short side of the tile, so that a sliding movement can be made, with the aid of the appropriate handling system, to help ensure the 'flattening' of the adhesive lines.

### 7. Tile placement

The tile shall be installed using at least two operators and the necessary tools.

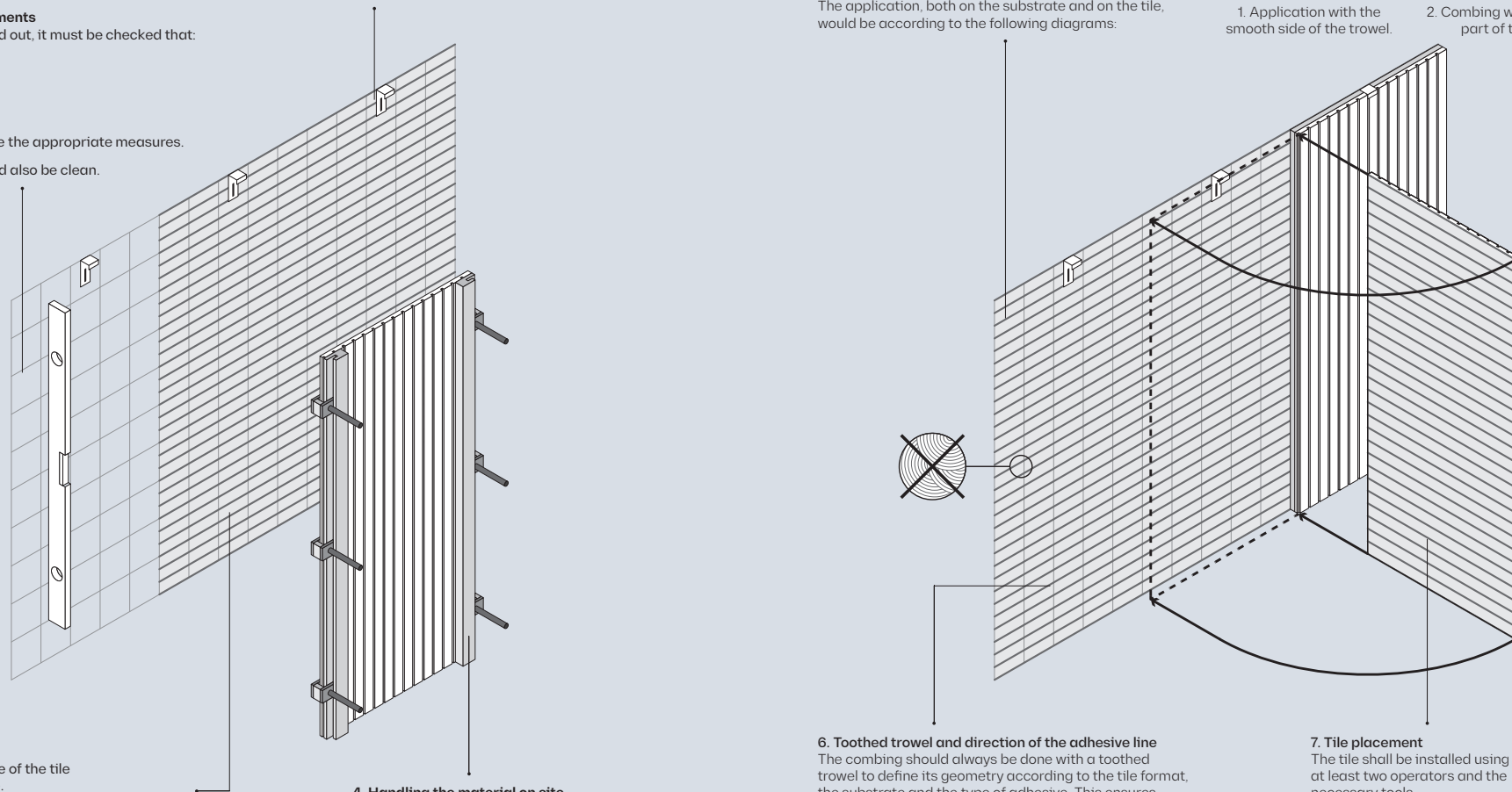



### 8. Vibrating after installation

To facilitate air to be released and better contact between the tile and the substrate, a post-installation vibrating must be employed and not 'hammering', getting 'flatten' the adhesive lines and avoiding air bubbles behind the tile.

The vibrating of the tile shall be carried out according to the format used:

- Manually, for small format tiles.
- Mechanically, for large format tiles.

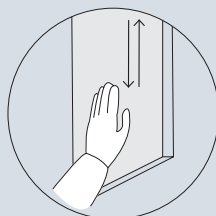

→ Manually,  
for small format tiles.

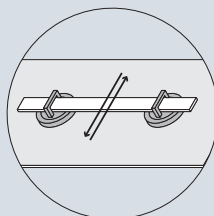

→ Mechanically,  
for large format tiles.

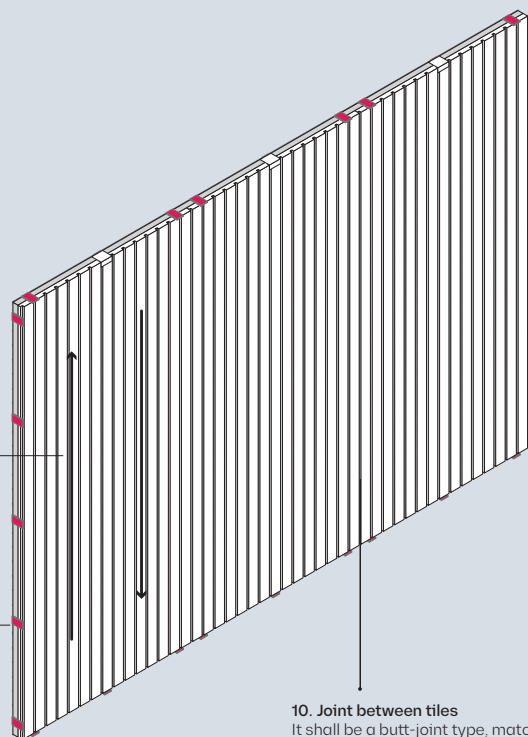

### 9. Joints with other elements

The following minimum joints must always be maintained:

- With flooring  $\geq 2$  mm [1/16"].
- With ceiling  $\geq 4$  mm [1/8"].
- With side walls  $\geq 4$  mm [1/8"].

The use of spacers is recommended in order to comply with the stipulated joint width.

### 10. Joint between tiles

It shall be a butt-joint type, matching the surface groove of one tile with the non-grooved surface of the next tile, achieving a continuity in the pattern.

The tiles should not be in contact with each other.

For this type of joint, no grouting is required.

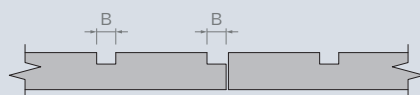

### 11. Grouting material

When filling the joints, the appropriate grout (type CG2) and consistency should be chosen and applied according to the manufacturer's instructions.

It is advisable to use a rubber trowel of the appropriate hardness to the width of the joint to extend the material diagonally to the direction of the joints.

The final texture and curvature will be set on the joint using a pointing trowel or equivalent tool.

In some cases, flexible stainless steel scrapers or extrusion guns can be used to apply the grout.

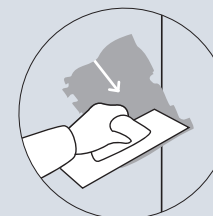

1. Application of the  
grout with trowel.

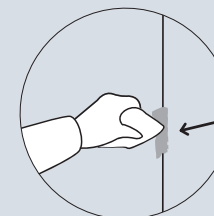

2. Making curve  
and texture.

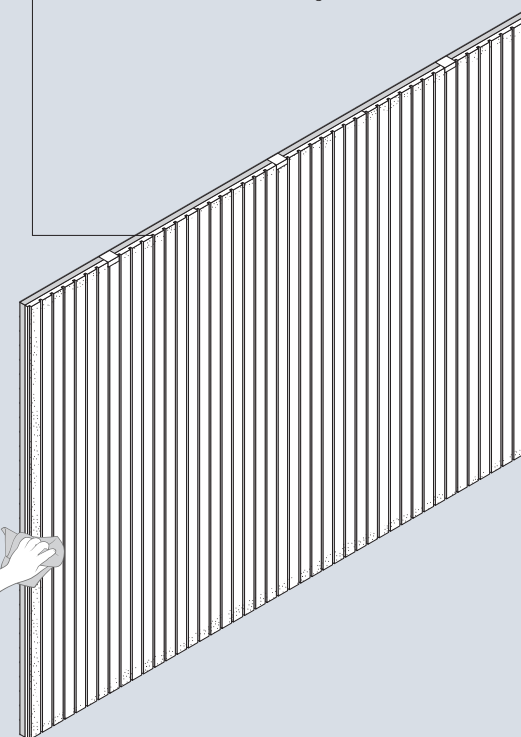

### 10. Final cleaning of the job

After installation, the surface usually has residues such as small traces of cement, limescale, silicone, epoxy, etc.

It is therefore necessary to do a final cleaning of the job, according to the following procedure:

- a. Application of the acid descaling product (e.g. Fila Deterdek Pro), according to the dilution and time of action indicated by the manufacturer.
- b. Using a soft bristle scrub brush (nylon type), distribute the descaling agent so that the product reaches uniformly the whole surface of the material.
- c. Rinse with water, using a low pressure washer.

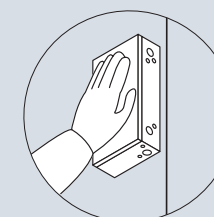

## Health & safety

Operators and fitters dealing with Dekton® materials, must comply with all applicable occupational health and safety laws and regulations.

Always take the necessary occupational safety measures to meet the requirements of local regulations. This *Guide* is not an exhaustive document or a substitute for the relevant laws and regulations, and is provided for information purposes only.

Safety measures will depend on the specific conditions of each job.

### Risks associated with handling and transport

During transport and handling of Dekton® materials, risks such as bumps, cuts, musculoskeletal disorders, entrapment or blast injuries can occur due to incorrect handling.

### Risks associated with manufacturing and transformation

The manufacturing process can involve risks such as cuts, blast injuries, entrapment, exposure to high noise levels and exposure to chemicals such as free crystalline silica dust.

Before processing the product, consult the Dekton® *Safety Data Sheet* and the *Good Practice Guidelines* available upon request from Cosentino® or on the website [osh.cosentino.com](http://osh.cosentino.com).

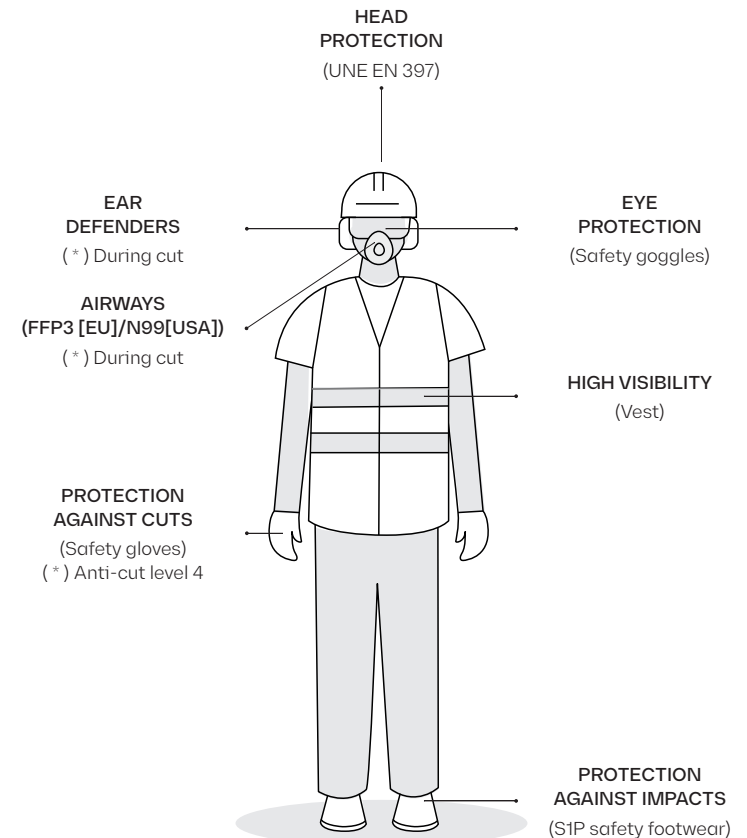



## Use & maintenance

### Final cleaning of the job

After the installation of Dekton® UKIYO, the surface usually has residues such as small traces of cement, limescale, silicone, epoxy, etc.

It is therefore necessary to do a final cleaning of the job to leave the Dekton® surface clean and, at the same time, not to damage the grout.

It is important to clean up grout residues from the installation work as soon as possible.

→ Procedure

1. **Application** of the product on the surface. Dilution and how long the product should be left to act according to manufacturer's instructions.

**Reference product**

Fila Deterdek Pro or similar  
(Buffered acid detergent).

2. **Distribute** the product, with a scrub brush, to ensure that it reaches uniformly the entire surface of the material.

**Reference product**

Nylon-type, soft bristle scrub brush.

3. **Rinse** with water, using a low pressure washer.

**Reference product**

Pressure washers with water pressure of 120 - 160 bar, Kärcher/Bosch-type or similar.

### Maintenance cleaning

→ Procedure

1. **Application** of the product on the surface. Dilution and how long the product should be left to act according to manufacturer's instructions.

**Reference product**

Faber Deterfug, 3% solution, or similar  
(Slightly acidic detergent).

2. **Distribute** the product, with a scrub brush, to ensure that it reaches uniformly the entire surface of the material.

**Reference product**

Nylon-type, soft bristle scrub brush.

3. **Rinse** with water, using a low pressure washer.

**Reference product**

Pressure washers with water pressure of 120 - 160 bar, Kärcher/Bosch-type or similar.

### Daily cleaning

→ Procedure

**Application**, with pressure washer, of pressurized water up to 120 - 140 bar.

**Reference product**

Pressure washers with water pressure of 120 - 160 bar, Kärcher/Bosch-type or similar.

## **COSENTINO**

Ctra. Baza a Huercal-Overa, km 59 / 04850  
Cantoria - Almeria (Spain) / Tel.: +34 950 444 175  
[info@cosentino.com](mailto:info@cosentino.com) / [www.cosentino.com](http://www.cosentino.com)



REV. 01 - 12/2023  
PRINT DATE: DECEMBER 2023